

Application

- A nut tightening pipe connection tool for devices that use pneumatic piping.

Features

- The connection method is nut tightening and efficient in environments with vibration.
- Made from plastics to be semi-permanent, has good tolerance to corrosion and chemicals.
- Suited for low air pressure devices.

Specifications

- Fluid type : Air (No other gases or liquids)
- Working pressure: 0~150PSI / 0~9.9Kgf/cm² (0~990kPa)
- Negative pressure: -29.5 in Hg / -750mmHg (-750Torr)
- Working temperature: 32~140° F / 0~60° C
- Applicable Tube: Polyurethane and Nylon

Structural Diagram

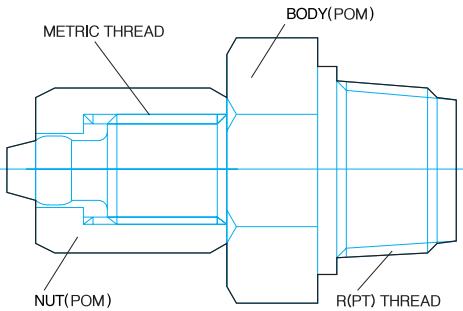

Two -Touch Fittings



MODEL	ØD	T	L	A	H1(Hex)	H2(Hex)	WEIGHT(g)	BOX(EA)
CK 06-01	6	R1/8	27.5	7.0	12	13	2.7	100
CK 06-02		R1/4	30.5	9.0		15	4.3	100
CK 08-01	8	R1/8	29.5	9.0	14	14	3.6	100
CK 08-02		R1/4	29.0	9.0		15	4.6	100
CK 08-03	10	R3/8	31.7	10.2	17	19	6.5	100
CK 10-02		R1/4	33.4	9.2		17	6.1	100
CK 10-03	12	R3/8	34.4	10.2	19	19	7.5	50
CK 12-02		R1/4	39.0	9.2		17	7.8	50
CK 12-03		R3/8	41.2	10.2		19	8.7	50

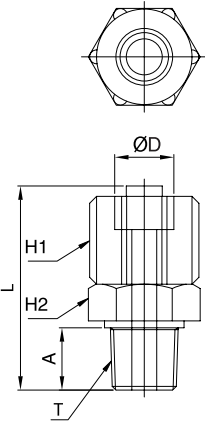

CAUTION

- Be sure to refer to Caution Safety, Classification of Warning Indications (P7), and Common Caution of Fitting Products (P8) before use.
- The product is made from plastics and the screw section is not treated with Teflon coating so that a Teflon tape treatment before installation can be efficient to prevent air leakage.
- Be sure to prevent pressure buildup due to twisting, pulling, and bending of the fitting product. It may cause product damage or air leakage.
- To connect the tube, insert the tube to the end, and join the cap before use.
- Cut the pressed part of the tube before connection for reuse of the released tube.
- Be sure to prevent excessive pressure when tightening the screw because the product is made from plastics.

Product Code System

METRIC - BSPT(R)

CK 06-01

Two-Touch Fitting			Tube Dia		Thread Size	
CODE	OD	ID	CODE	OD	CODE	SIZE
04	Ø4	Ø2.5	01	Ø4	01	R1/8
06	Ø6	Ø4		Ø6	02	R1/4
08	Ø8	Ø5.5		Ø8	03	R3/8
10	Ø10	Ø6.5		Ø10		
12	Ø12	Ø8		Ø12		



MODEL	ØD	T	L	E	A	H(Hex)	WEIGHT(g)	BOX(EA)
GCK 06-01	6	R1/8	24.5	26.0	7.0	12	4.1	100
GCK 06-02		R1/4	26.5	29.5	9.0		5.5	100
GCK 08-01	8	R1/8	24.5	25.5	8.0	14	4.8	100
GCK 08-02		R1/4	26.5	29.0	10.0		6.0	100
GCK 08-03	10	R3/8	27.5	32.5	11.0	17	9.2	50
GCK 10-02		R1/4	30.0	32.0	12.0		8.7	50
GCK 10-03	12	R3/8	31.0	34.7	12.0	19	10.8	50
GCK 12-02		R1/4	32.0	41.5	11.0		13.0	50
GCK 12-03		R3/8	34.0	41.5	12.0		14.4	50

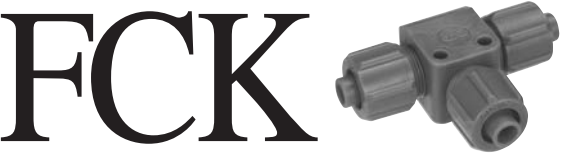
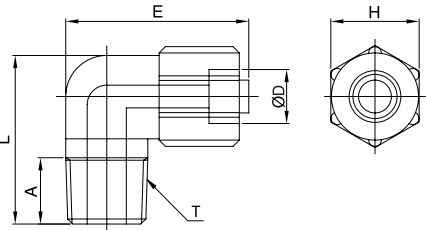

MODEL	ØD	L	E	C	M1	M2	H(Hex)	WEIGHT(g)
FCK 06	6	31.1	48.3	4.3	5.7	11.2	12	50
FCK 08	8	32.0	18.0	4.3	6.6	12.2	14	50
FCK 10	10	40.0	54.0	4.3	8.3	13.4	17	25
FCK 12	12	47.7	68.0	4.3	9.3	13.7	19	20

