

Compact Guide Cylinder /Wide type **New**

ø20, ø25, ø32, ø40, ø50, ø63

Doubling the guide pitch

doubles the allowable plate rotational torque.

◆ Allowable rotational torque

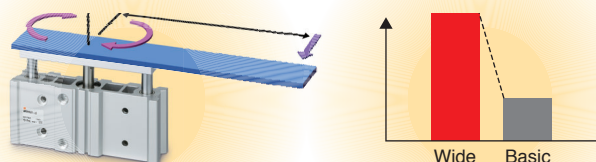

0.75 N·m → 1.63 N·m

For MGPWM20-50

- The allowable rotational torque of the plate is improved by up to 3 times by making the guide pitch twice the basic type and placing the guide components at an optimal location.
- Suitable when used as a pusher or lifter.

Non-rotating accuracy of the plate improved

◆ Non-rotating accuracy

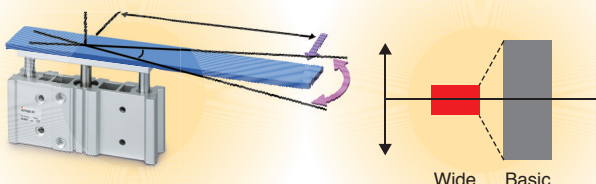

±0.09° → ±0.03°

Basic type

For MGPL20

Wide type

For MGPWL20

- The plate non-rotating accuracy is improved due to the increase in guide pitch.

Equivalent weight to the basic type



- Although the volume is 170% more than the MGP basic type, the weight of the MGP wide type is equivalent to the basic type by changing the plate material and optimising the component dimensions.

Series **MGPW**



CAT.EUS20-228A-UK

3 bearing types are available for various applications.

Slide bearing Series MGPWM

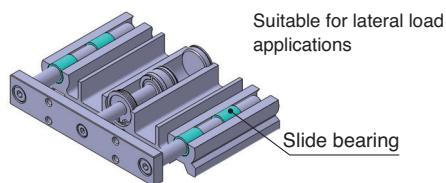

Ball bushing Series MGPWL

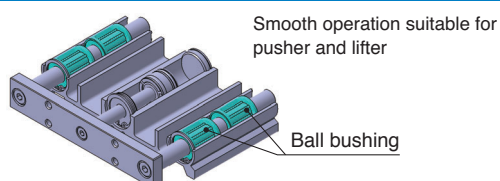

High precision ball bushing Series MGPWA

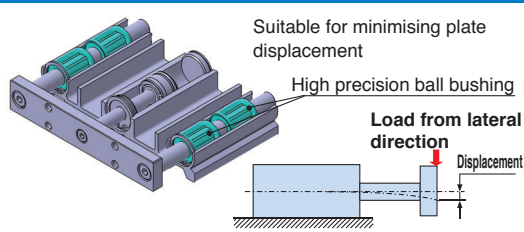

Transfer of large workpieces

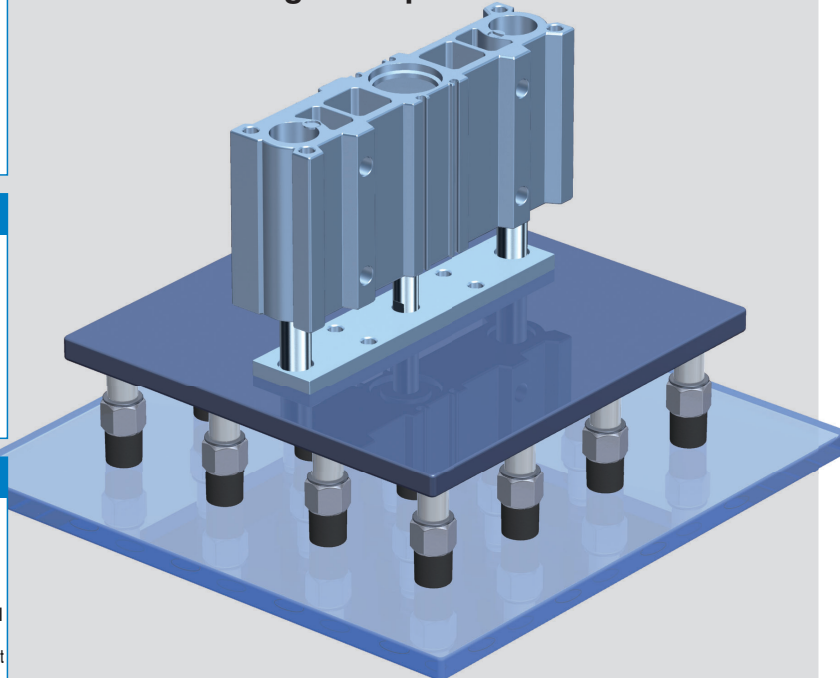

Knock pin hole is available as made to order.

If a knock pin is required on the plate or body, "-XC56: With knock pin holes" model is available as a made to order.

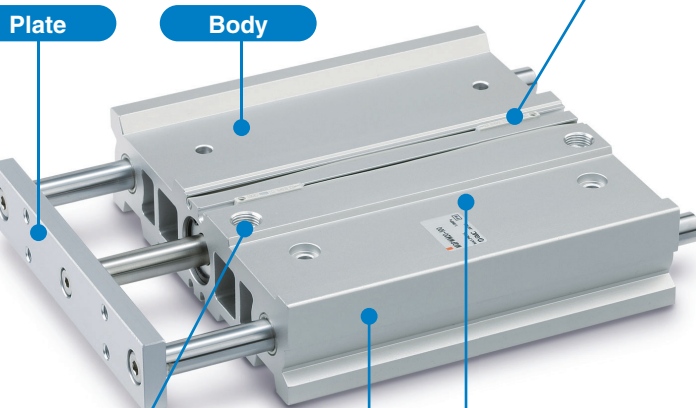

Top ported

Side porting is available as made to order.

The port is located on the top of the body in the standard type, but if side porting is required, it is also available. (-X867: Side porting type)

Small auto switches or magnetic field resistant auto switches can be mounted on 2 surfaces.

2-colour display solid state auto switch
D-M9

Reed auto switch
D-A9

Magnetic field resistant 2-colour display solid state auto switch
D-P3DWA

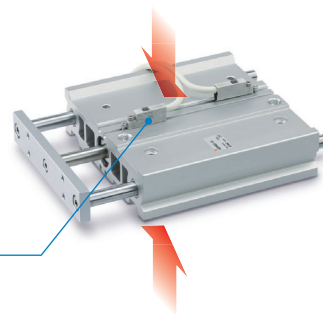

*The D-Y7 and D-Z7 auto switches are not mountable.

3 mounting types are possible.

1. Top mounting

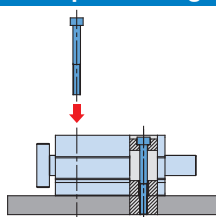

2. Side mounting

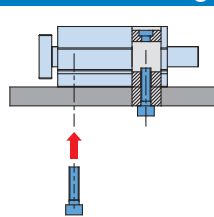



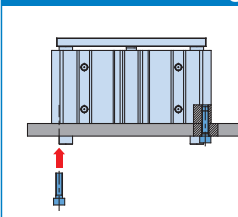





3. Bottom mounting

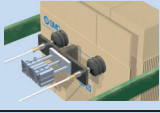
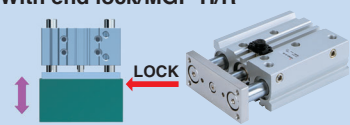
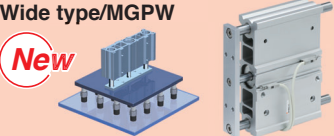

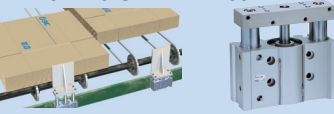
Series MGPW

Compact Guide Cylinders, Series Variations

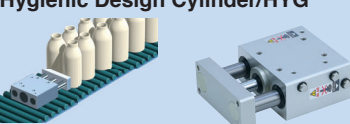
Series	Bearing type	Bore size [mm]												Page
		6	10	12	16	20	25	32	40	50	63	80	100	
Basic type/MGP 	Slide bearing Ball bushing High precision ball bushing			●	●	●	●	●	●	●	●	●	●	 www.smc.eu
With air cushion/MGP-A 					●	●	●	●	●	●	●	●	●	
With end lock/MGP-H/R 						●	●	●	●	●	●	●	●	
Wide type/MGPW 	Slide bearing Ball bushing High precision ball bushing					●	●	●	●	●	●			Page 2 of this catalogue
Clean series/12/13-MGP 	Ball bushing			●	●	●	●	●	●	●	●			
Water-resistant/MGP R/V 	Slide bearing					●	●	●	●	●	●	●	●	
Heavy duty guide rod type/MGPS 										●		●		 www.smc.eu
Miniature Guide Rod Cylinder/MGJ 		●	●											
Compact Guide Cylinder with Lock/MLGP 	Slide bearing Ball bushing					●	●	●	●	●	●	●	●	
Hygienic Design Cylinder/HYG 	Slide bearing					●	●	●	●	●	●			

Series MGPW (Wide type), Stroke Variations

Bearing type	Bore size [mm]	Stroke [mm]							
		25	50	75	100	125	150	175	200
MGPWM Slide bearing	20	●	●	●	●	●	●	●	●
	25	●	●	●	●	●	●	●	●
MGPWL Ball bushing	32	●	●	●	●	●	●	●	●
	40	●	●	●	●	●	●	●	●
MGPWA High precision ball bushing	50	●	●	●	●	●	●	●	●
	63	●	●	●	●	●	●	●	●



Series MGPW Specific Product Precautions

Be sure to read before handling. Refer to back cover for Safety Instructions, "Handling Precautions for SMC Products" (M-E03-3) and the Operation Manual for Actuator Precautions and Auto Switch Precautions. Please download it via our website, <http://www.smcworld.com>

Mounting

Warning

1. Never place your hands or fingers between the plate and the body.

Be very careful to prevent your hands or fingers from getting caught in the gap between the cylinder body and the plate when air is applied.

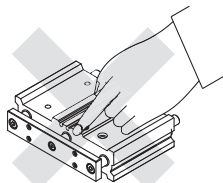

Caution

1. Use cylinders within the piston speed range.

An orifice is set for this cylinder, but the piston speed may exceed the operating range if the speed controller is not used. If the cylinder is used outside the operating speed range, it may cause damage to the cylinder and shorten the service life. Adjust the speed by installing the speed controller and use the cylinder within the limited range.

2. Pay attention to the operating speed when the product is mounted vertically.

When using the product in the vertical direction, if the load factor is large, the operating speed can be faster than the control speed of the speed controller (i.e. quick extension). In such cases, it is recommended to use a dual speed controller.

3. Do not scratch or gouge the sliding portion of the piston rod and the guide rod.

Damaged seals, etc. will result in leakage or malfunction.

4. Do not dent or scratch the mounting surface of a body and a plate.

The flatness of the mounting surface may not be maintained, which would cause an increase in sliding resistance.

5. Make sure that the cylinder mounting surface has a flatness of 0.05 mm or less.

Insufficient flatness of a workpiece or bracket mounted on the mounting surface or plate of the cylinder and other parts can cause defective operation and an increase in the sliding resistance.

6. Bottom of cylinder

The guide rods protrude from the bottom of the cylinder at the end of the retracting stroke, and therefore, in cases where the cylinder is to be bottom mounted, it is necessary to provide bypass ports in the mounting surface for the guide rods, as well as holes for the hexagon socket head cap screws which are used for mounting.

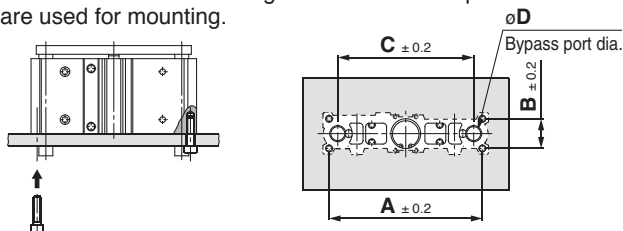

Bore size [mm]	A [mm]	B [mm]	C [mm]	D [mm]		Hexagon socket head cap screw
				MGPWM	MGPWL/A	
20	126	24	108	12	12	M5 x 0.8
25	146	30	128	14	15	M6 x 1.0
32	176	34	156	18	18	M8 x 1.25
40	192	40	172	18	18	M8 x 1.25
50	240	46	220	22	22	M10 x 1.5
63	266	58	248	22	22	M10 x 1.5

Mounting

Caution

7. Tighten the screws to the correct tightening torques specified in the table below when mounting parts on top of the cylinder.

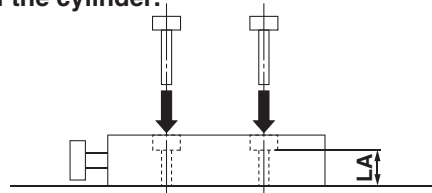

Bore size [mm]	Hexagon socket head cap screw	Tightening torque [N·m]	LA dimension [mm]
20	M5	3.0 to 4.0	30.5
25			36.5
32			40.5
40	M6	5.2 to 6.4	46.5
50			54.5
63			68.5

Allowable Kinetic Energy

Caution

Load weight and a maximum speed must be within the ranges shown in the graph below.

MGPW with Rubber Bumper

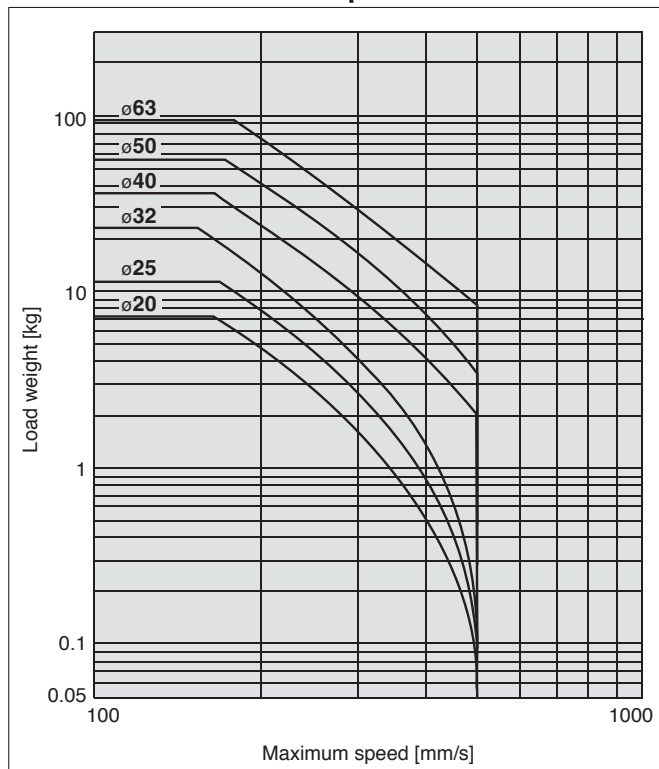

Other

Caution

Do not use this cylinder as a stopper.

Compact Guide Cylinder/Wide Type

Series *MGPW*

ø20, ø25, ø32, ø40, ø50, ø63

How to Order

Compact Guide Cylinder

MGP W M 25 — **50** — **M9BW**

Compact Guide Cylinder

Wide type

Bearing type

M	Slide bearing
L	Ball bushing
A	High precision ball bushing

Bore size

20	20 mm	40	40 mm
25	25 mm	50	50 mm
32	32 mm	63	63 mm

Port thread type

—	Rc
TN	NPT
TF	G

Number of auto switches

—	2 pcs.
S	1 pc.
n	n pcs.

Auto switch

—	Without auto switch (Built-in magnet)
---	---------------------------------------

* For applicable auto switch model, refer to the table below.

Cylinder stroke [mm]

Refer to "Standard Strokes" on page 3.

Applicable Auto Switches/Refer to pages 1719 to 1827 in Best Pneumatics No. 3 for further information on auto switches.

Type	Special function	Electrical entry	Indicator light	Wiring (Output)	Load voltage		Auto switch model		Lead wire length [m]				Pre-wired connector	Applicable load		
					DC	AC	Perpendicular	In-line	0.5 (—)	1 (M)	3 (L)	5 (Z)				
Solid state auto switch	—	Grommet	Yes	3-wire (NPN)	24 V	5 V, 12 V	—	M9NV	M9N	●	●	●	○	○	IC circuit	Relay, PLC
	3-wire (PNP)			M9PV				M9P	●	●	●	○	○			
	2-wire			M9BV				M9B	●	●	●	○	○			
	3-wire (NPN)			M9NWV				M9NW	●	●	●	○	○			
	3-wire (PNP)			M9PWV				M9PW	●	●	●	○	○			
	2-wire			M9BWV				M9BW	●	●	●	○	○			
	3-wire (NPN)			M9NAV***				M9NA***	○	○	●	○	○			
	3-wire (PNP)			M9PAV***				M9PA***	○	○	●	○	○			
	2-wire			M9BAV***				M9BA***	○	○	●	○	○			
	Magnetic field resistant (2-colour display)			2-wire (Non-polar)				—	—	P3DWA**	●	—	●	●		
Reed auto switch	—	Grommet	Yes	3-wire (NPN equivalent)	—	5 V	—	A96V	A96	●	—	●	—	—	IC circuit	—
				2-wire	24 V	12 V	100 V	A93V	A93	●	●	●	●	—	—	
						100 V or less	A90V	A90	●	—	●	—	—	—	IC circuit	

*** Water-resistant type auto switch can be mounted to the models with the above mentioned part numbers, but this does not guarantee the water resistance of the cylinder. A water-resistant type cylinder is recommended for use in an environment which requires water resistance.

* Lead wire length symbols: 0.5 m — (Example) M9NV
1 m M (Example) M9NWM
3 m L (Example) M9NWL
5 m Z (Example) M9NWX

* Solid state auto switches marked with "○" are produced upon receipt of order.

** Bore sizes ø32 to ø63 are available for the D-P3DWA□.

* Since there are other applicable auto switches than listed, refer to page 19 for details.

* For details about auto switches with pre-wired connector, refer to Auto Switch guide.

For the D-P3DW□, refer to the D-P3DW catalogue.

* Auto switches are shipped together, (but not assembled).

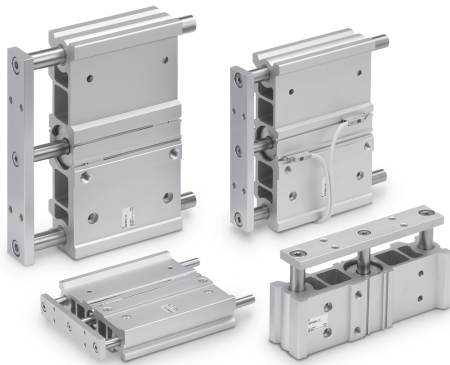

Specifications

Bore size [mm]	20	25	32	40	50	63
Action	Double acting					
Fluid	Air					
Proof pressure	1.5 MPa					
Maximum operating pressure	1.0 MPa					
Minimum operating pressure	0.1 MPa					
Ambient and fluid temperature	-10 to 60°C (No freezing)					
Piston speed ^{Note)}	50 to 500 mm/s					
Cushion	Rubber bumper on both ends					
Lubrication	Not required (Non-lube)					
Stroke length tolerance	$+1.5$ 0 mm					

Note) Speed with no load

Standard Strokes

Bore size [mm]	Standard stroke [mm]
20 to 63	25, 50, 75, 100, 125, 150, 175, 200

Manufacture of Intermediate Strokes

Description	Spacer installation Spacers are installed in the standard stroke cylinder. • ø20 to ø32: Available by the 1 mm stroke interval. • ø40 to ø63: Available by the 5 mm stroke interval.	
Part no.	Refer to "How to Order" for the standard model numbers.	
Applicable stroke [mm]	ø20 to ø32	1 to 199
	ø40 to ø63	5 to 195
Example	Part no.:MGPWM20-49 A spacer 1 mm in width is installed in a MGPWM20-50. C dimension (Body length): 84 mm	

Refer to pages 18 to 20 for cylinders with auto switches.

- Auto switch proper mounting position (detection at stroke end) and its mounting height
- Minimum stroke for auto switch mounting
- Auto switch mounting brackets/Part no.



Made to Order
(For details, refer to pages 22 and 23.)

Symbol	Description
-XC56	With knock pin holes
-X867	Side porting type

Theoretical Output

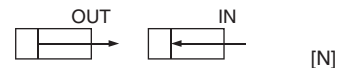

Bore size [mm]	Rod size [mm]	Operating direction	Piston area (mm ²)	Operating pressure [MPa]									
				0.2	0.3	0.4	0.5	0.6	0.7	0.8	0.9	1.0	
20	10	OUT	314	63	94	126	157	188	220	251	283	314	
		IN	236	47	71	94	118	141	165	188	212	236	
25	10	OUT	491	98	147	196	245	295	344	393	442	491	
		IN	412	82	124	165	206	247	289	330	371	412	
32	14	OUT	804	161	241	322	402	483	563	643	724	804	
		IN	650	130	195	260	325	390	455	520	585	650	
40	14	OUT	1257	251	377	503	628	754	880	1005	1131	1257	
		IN	1103	221	331	441	551	662	772	882	992	1103	
50	18	OUT	1963	393	589	785	982	1178	1374	1571	1767	1963	
		IN	1709	342	513	684	855	1025	1196	1367	1538	1709	
63	18	OUT	3117	623	935	1247	1559	1870	2182	2494	2806	3117	
		IN	2863	573	859	1145	1431	1718	2004	2290	2576	2863	

Note) Theoretical output [N] = Pressure [MPa] x Piston area [mm²]

Weight

Slide Bearing: MGPWM

[kg]

Bore size [mm]	Standard stroke [mm]							
	25	50	75	100	125	150	175	200
20	0.63	0.86	1.11	1.33	1.54	1.76	1.98	2.20
25	0.84	1.11	1.47	1.74	2.01	2.28	2.55	2.82
32	1.31	1.71	2.22	2.61	3.00	3.38	3.77	4.15
40	1.53	1.98	2.54	2.97	3.40	3.83	4.26	4.69
50	2.45	3.12	4.01	4.66	5.31	5.96	6.61	7.26
63	3.25	4.07	5.12	5.91	6.71	7.51	8.31	9.11

Ball Bushing: MGPWL/High Precision Ball Bushing: MGPWA

[kg]

Bore size [mm]	Standard stroke [mm]							
	25	50	75	100	125	150	175	200
20	0.65	0.92	1.15	1.37	1.61	1.83	2.05	2.28
25	0.89	1.23	1.52	1.81	2.11	2.40	2.68	2.97
32	1.36	1.76	2.22	2.61	3.03	3.41	3.80	4.18
40	1.58	2.02	2.53	2.96	3.43	3.86	4.29	4.72
50	2.51	3.19	3.94	4.59	5.26	5.91	6.55	7.20
63	3.32	4.14	5.04	5.84	6.66	7.46	8.26	9.06

Allowable Rotational Torque of Plate

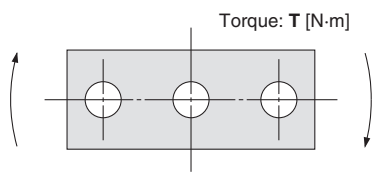

T [N·m]

Bore size [mm]	Bearing type	Stroke [mm]							
		25	50	75	100	125	150	175	200
20	MGPWM	2.10	1.63	1.74	1.51	1.34	1.20	1.08	0.99
	MGPWL/A	3.97	4.36	3.46	2.87	3.93	3.45	3.07	2.76
25	MGPWM	3.53	2.74	3.28	2.90	2.59	2.34	2.14	1.97
	MGPWL/A	6.88	6.78	5.43	4.51	6.27	5.51	4.90	4.40
32	MGPWM	7.98	6.39	7.00	6.19	5.54	5.02	4.59	4.22
	MGPWL/A	11.13	8.48	11.14	9.36	12.46	11.00	9.83	8.87
40	MGPWM	8.80	7.04	7.72	6.82	6.11	5.54	5.06	4.66
	MGPWL/A	12.26	9.34	12.27	10.31	13.73	12.12	10.83	9.77
50	MGPWM	17.57	14.28	16.17	14.44	13.04	11.89	10.93	10.11
	MGPWL/A	17.08	13.20	19.64	16.62	20.45	18.10	16.19	14.61
63	MGPWM	19.80	16.09	18.23	16.28	14.70	13.41	12.32	11.40
	MGPWL/A	19.18	14.81	22.07	18.66	22.98	20.33	18.18	16.39

Non-rotating Accuracy of Plate

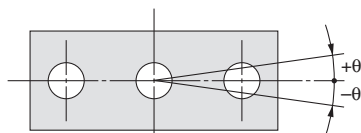

Non-rotating accuracy θ when the plate is retracted and when no load is applied is not more than the values shown in the table as a guide line.

Bore size [mm]	Non-rotating accuracy θ		
	MGPWM	MGPWL	MGPWA
20	$\pm 0.05^{\circ}$	$\pm 0.03^{\circ}$	$\pm 0.01^{\circ}$
25	$\pm 0.04^{\circ}$		
32			
40			
50	$\pm 0.03^{\circ}$		
63			

High Precision Ball Bushing/MGPWA Plate Displacement Amount (Reference Values)

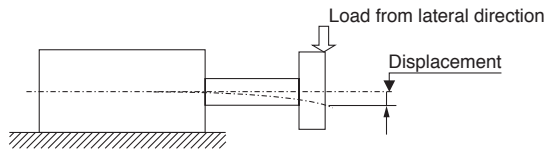

MGPWA20

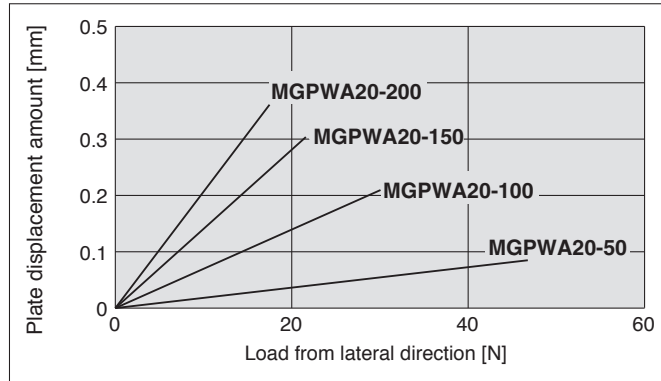

MGPWA32, 40

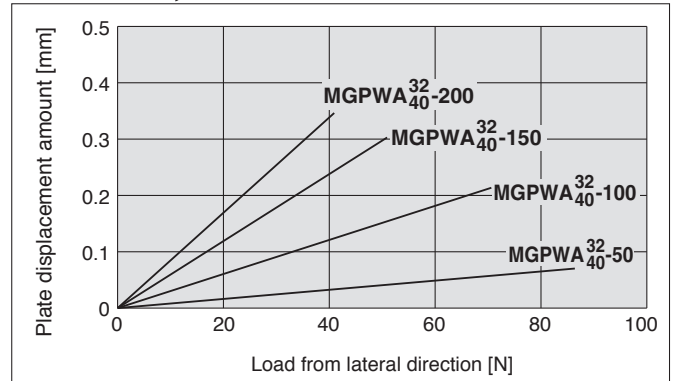

MGPWA25

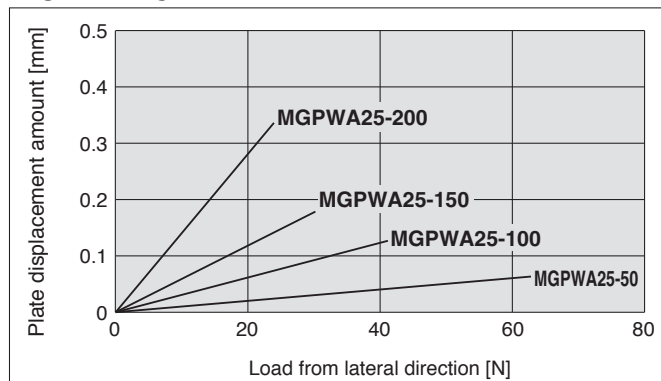

MGPWA50, 63

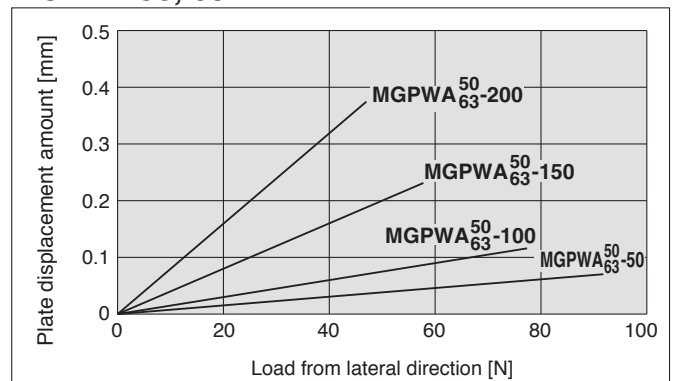

Note 1) The guide rod and self-weight for the plate are not included in the above displacement values.

Note 2) Allowable rotating torque, and operating range when used as a lifter, are the same as MGPWL series.

Series MGPW Model Selection

Selection Conditions

Mounting orientation	Vertical		Horizontal	
Maximum speed [mm/s]	200 or less	400	200 or less	400
Graph (Slide bearing type)	(1), (2)	(3), (4)	(17), (18)	(19), (20)
Graph (Ball bushing type)	(5) to (10)	(11) to (16)	(21) to (24)	(25) to (28)

Selection Example 1 (Vertical Mounting)

Selection conditions

Mounting: Vertical
Bearing type: Ball bushing
Stroke: 50 stroke
Maximum speed: 200 mm/s
Load weight: 3 kg
Eccentric distance: 90 mm

Find the point of intersection for the load weight of 3 kg and the eccentric distance of 90 mm on graph (6), based on vertical mounting, ball bushing, 50 stroke, and the speed of 200 mm/s.
→ **MGPWL20-50** is selected.

(6) 26 to 100 stroke, V = 200 mm/s or less

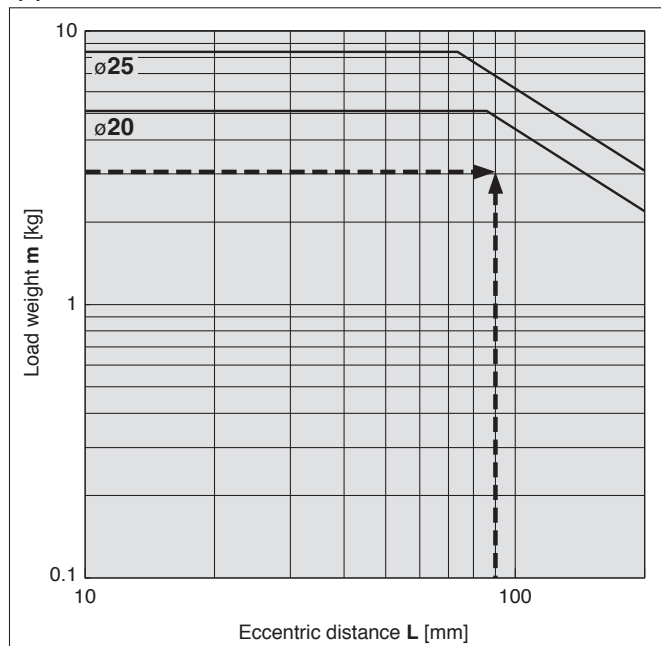

When the maximum speed exceeds 200 mm/s, the allowable load weight is determined by multiplying the value shown in the graph at 400 mm/s by the coefficient listed in the table below.

Max. speed	Up to 300 mm/s	Up to 400 mm/s	Up to 500 mm/s
Coefficient	1.7	1	0.6

Selection Example 2 (Horizontal Mounting)

Selection conditions

Mounting: Horizontal
Bearing type: Slide bearing
Distance between plate and load centre of gravity: 50 mm
Maximum speed: 200 mm/s
Load weight: 2 kg
Stroke: 30 stroke

Find the point of intersection for the load weight of 2 kg and 30 stroke on graph (17), based on horizontal mounting, slide bearing, the distance of 50 mm between the plate and load centre of gravity, and the speed of 200 mm/s.

→ **MGPWM20-30** is selected.

(17) L = 50 mm, V = 200 mm/s or less

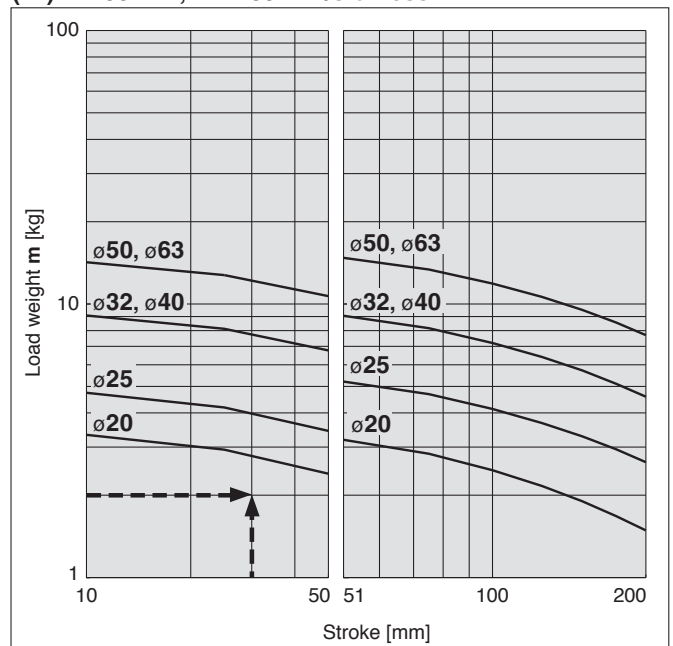

Vertical Mounting **Slide bearing**

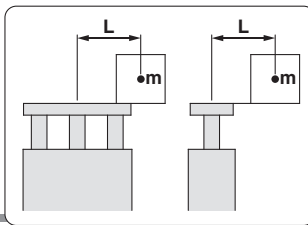

— Operating pressure 0.5 MPa

MGPWM20 to 63

(1) 50 stroke or less, $V = 200$ mm/s or less

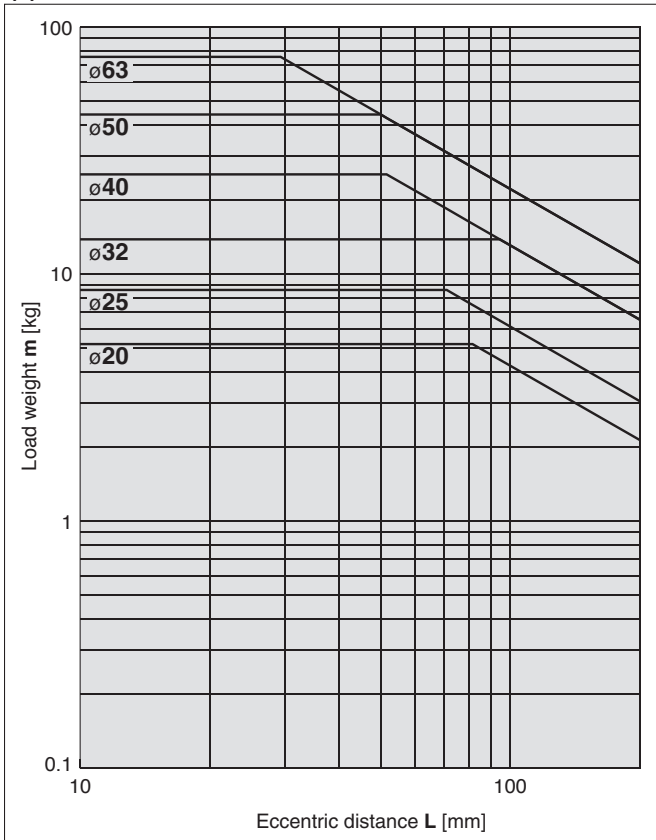

(2) Over 50 stroke, $V = 200$ mm/s or less

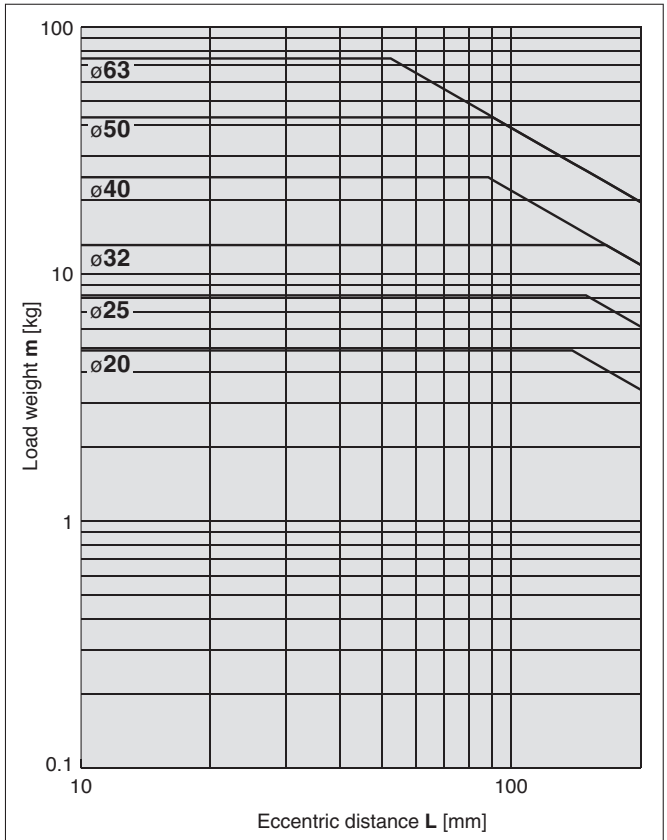

(3) 50 stroke or less, $V = 400$ mm/s or less

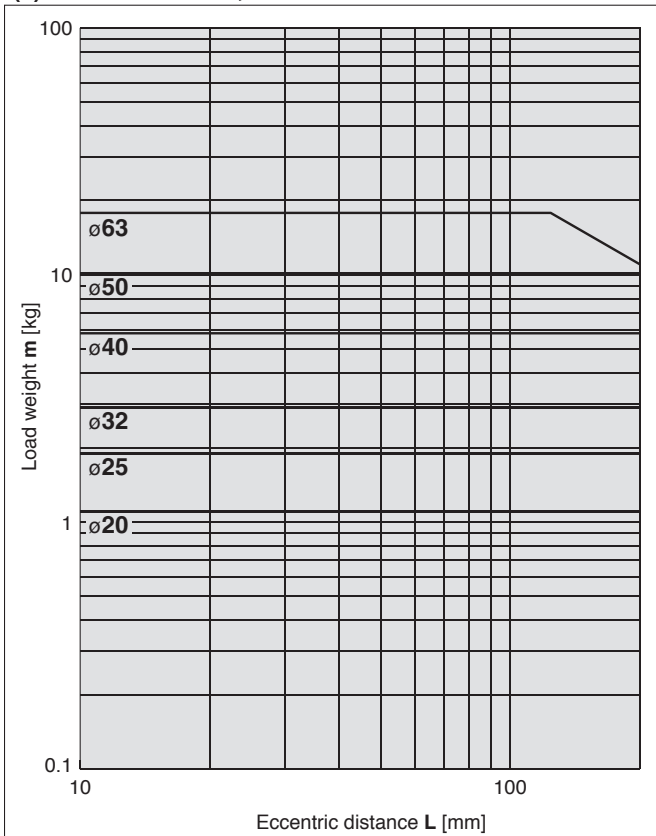

(4) Over 50 stroke, $V = 400$ mm/s or less

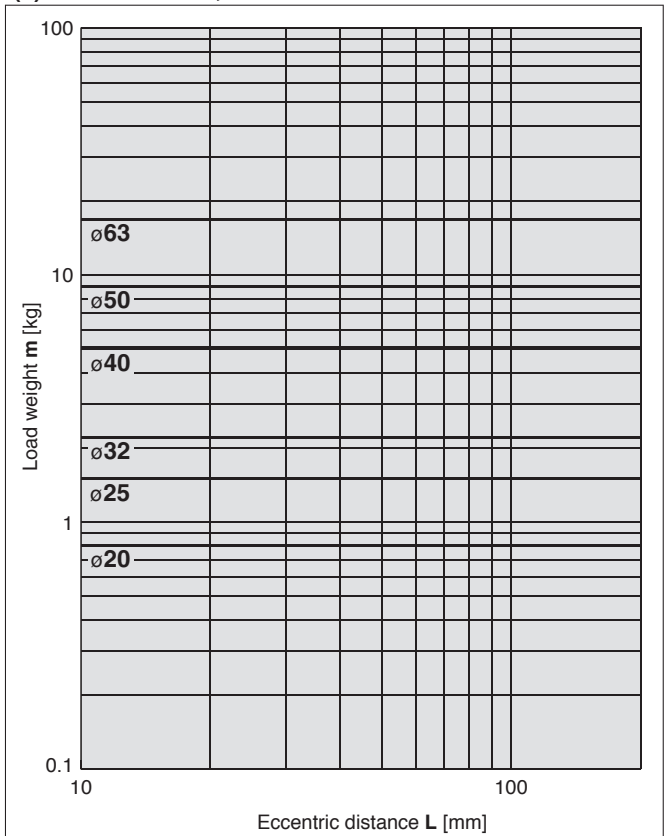

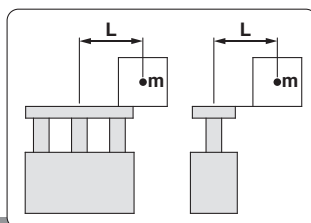

Vertical Mounting **Ball bushing**

— Operating pressure 0.5 MPa

MGPWL20 to 25, MGPWA20 to 25

(5) 25 stroke or less, $V = 200 \text{ mm/s}$ or less

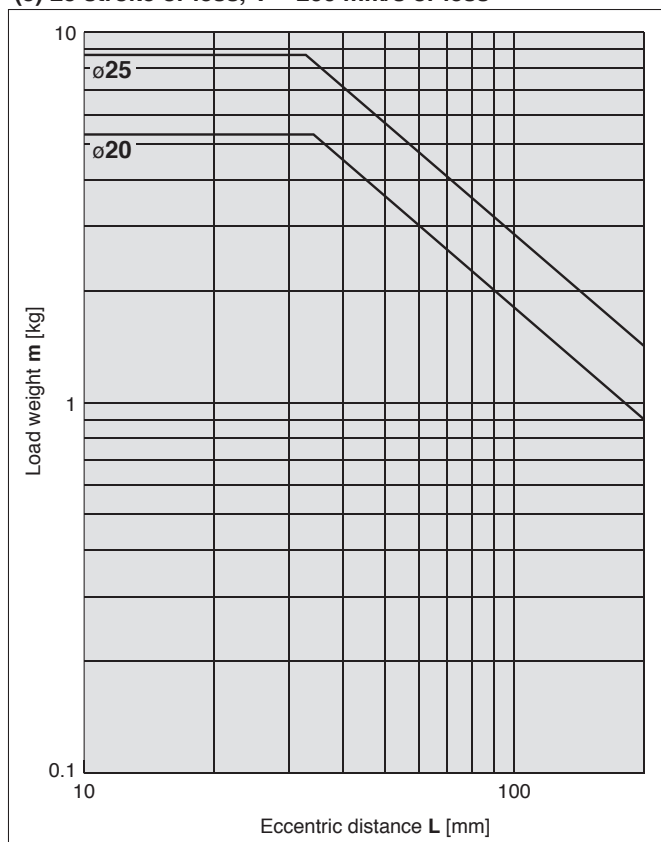

(6) Over 26 stroke, 100 stroke or less, $V = 200 \text{ mm/s}$ or less

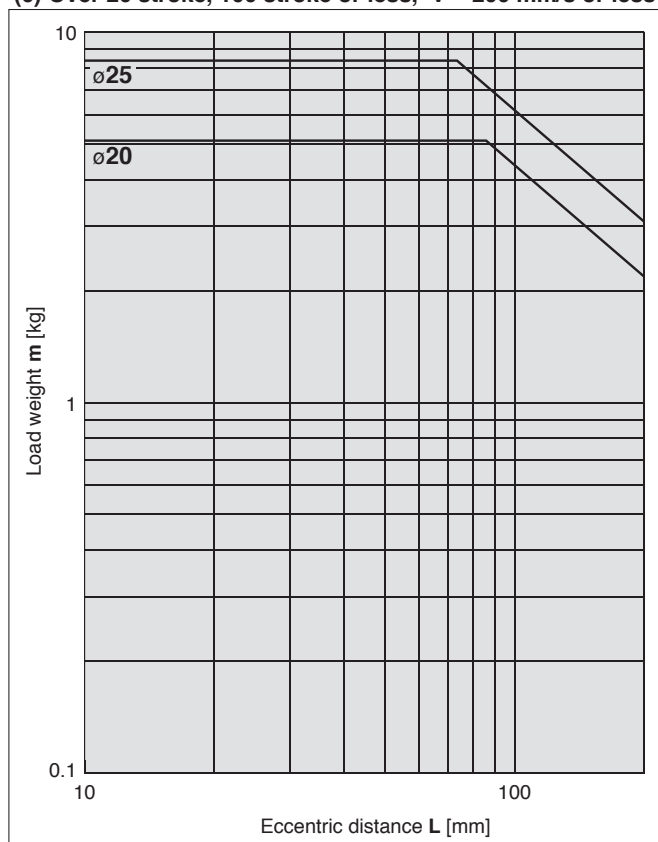

(7) Over 101 stroke, 200 stroke or less, $V = 200 \text{ mm/s}$ or less

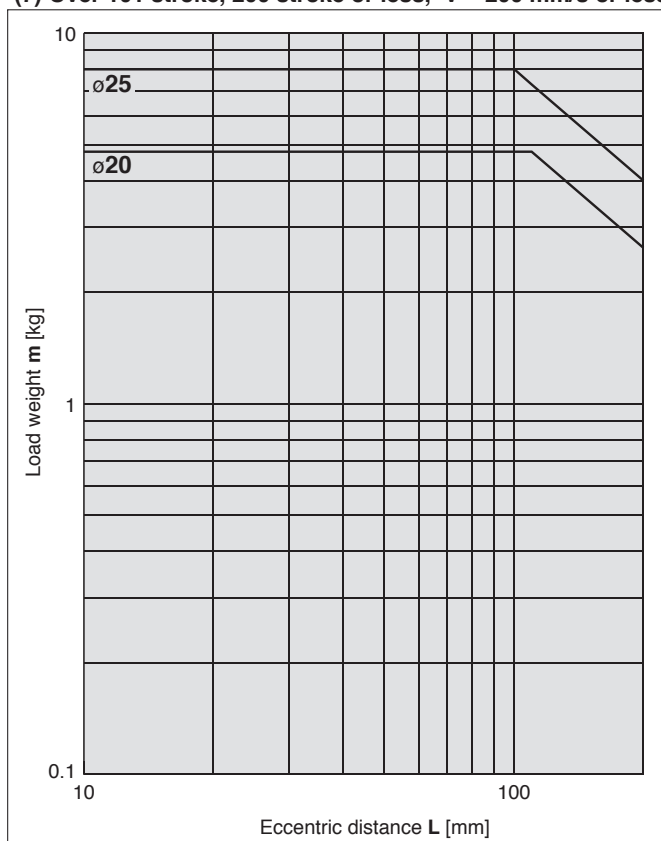

Vertical Mounting **Ball bushing**

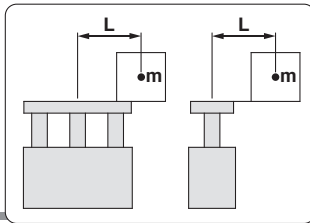

— Operating pressure 0.5 MPa

MGPWL32 to 63, MGPWA32 to 63

(8) 50 stroke or less, $V = 200 \text{ mm/s}$ or less

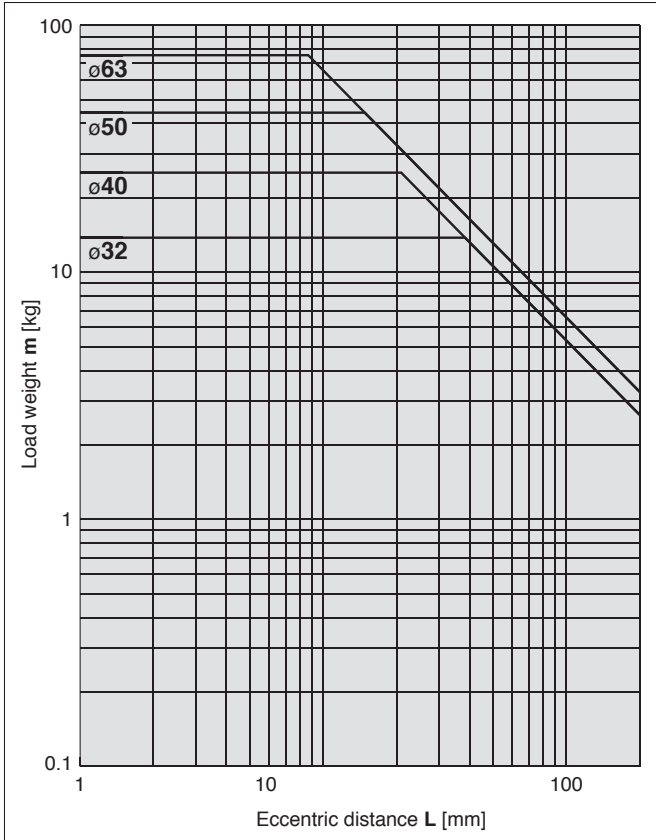

(9) Over 51 stroke, 100 stroke or less, $V = 200 \text{ mm/s}$ or less

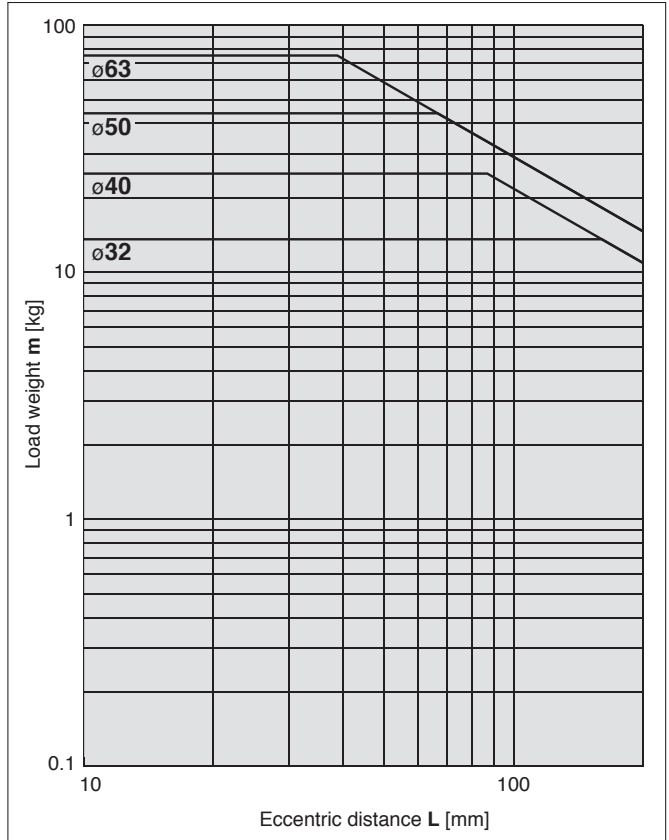

(10) Over 101 stroke, 200 stroke or less, $V = 200 \text{ mm/s}$ or less

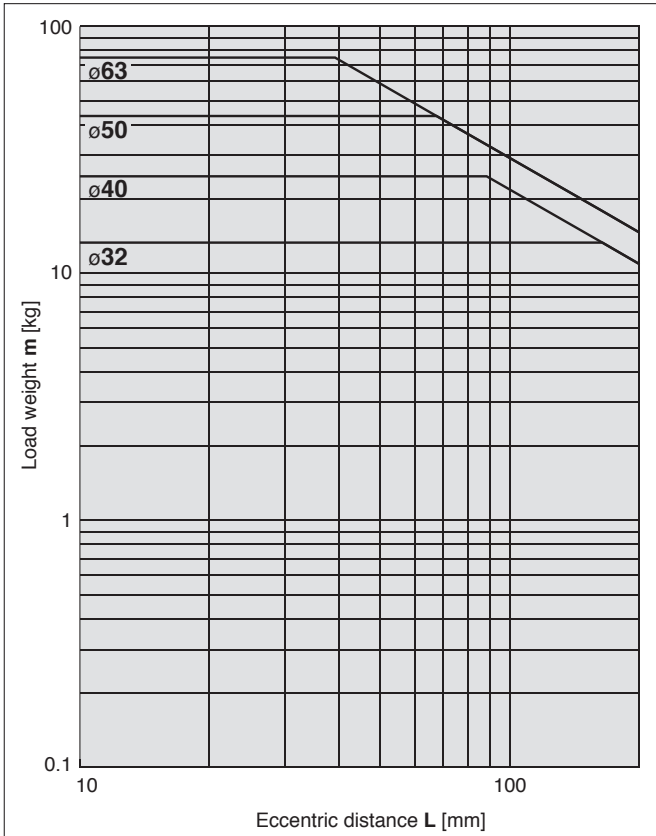

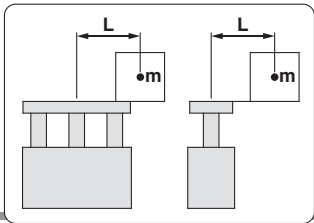

Vertical Mounting **Ball bushing**

Operating pressure 0.5 MPa

MGPWL20 to 25, MGPWA20 to 25

(11) 25 stroke or less, V = 400 mm/s

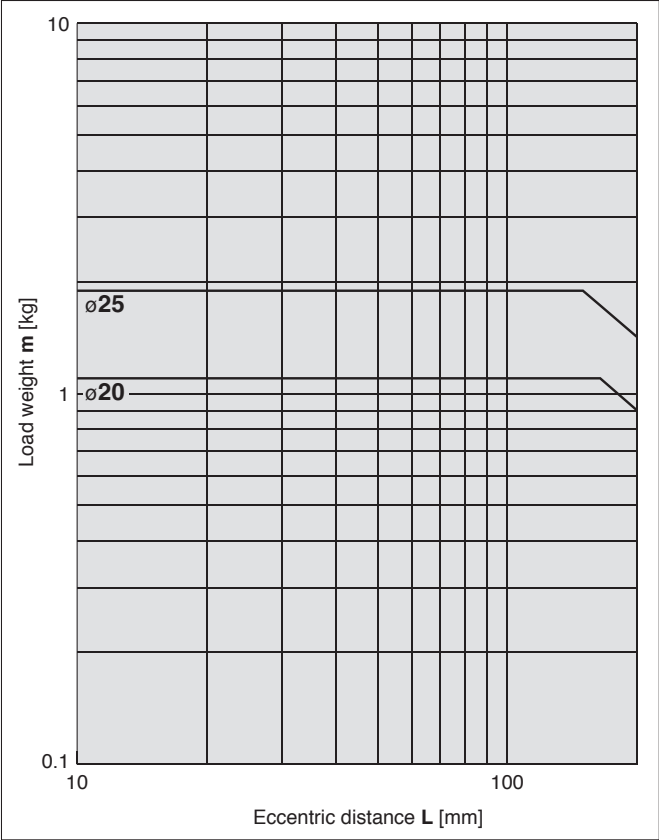

(12) Over 26 stroke, 100 stroke or less, V = 400 mm/s

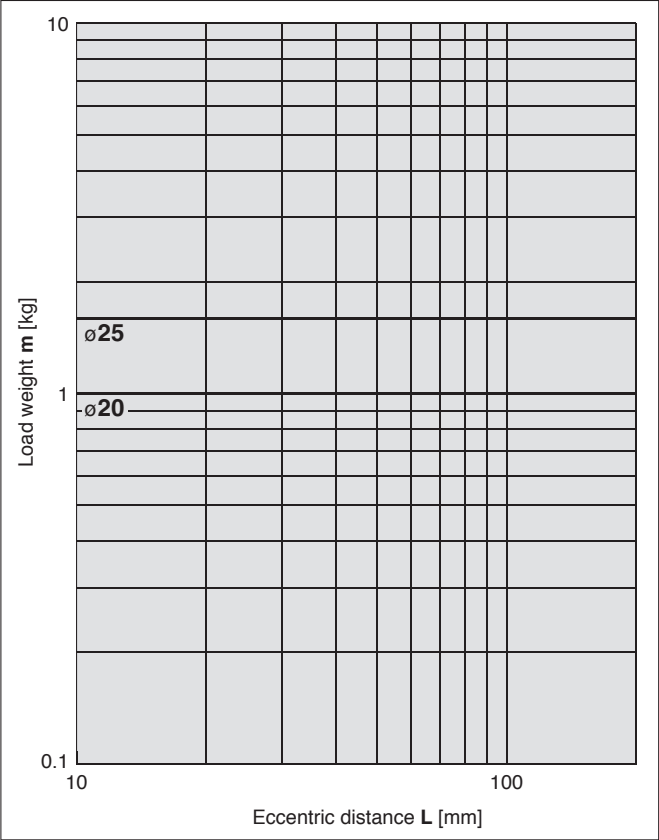

(13) Over 101 stroke, 200 stroke or less, V = 400 mm/s

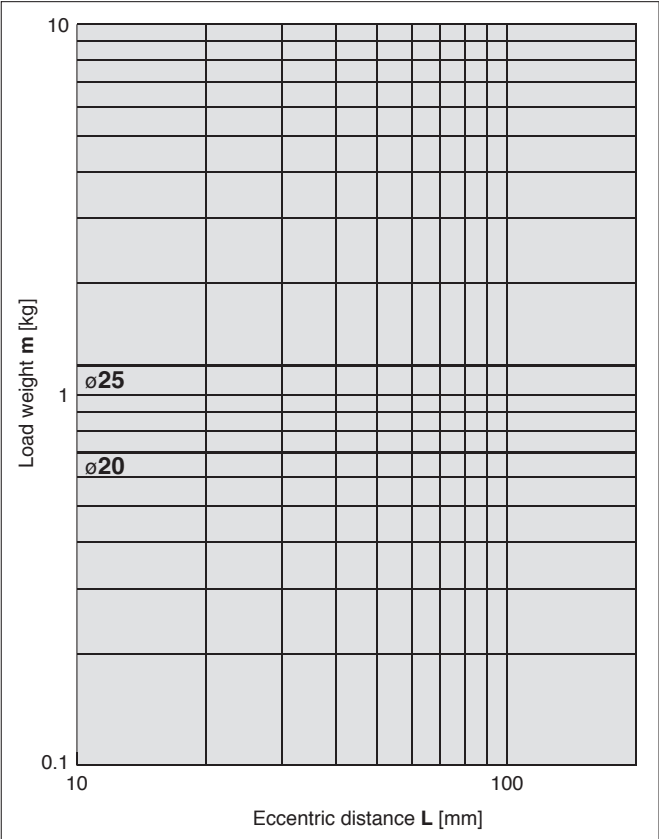

Vertical Mounting **Ball bushing**

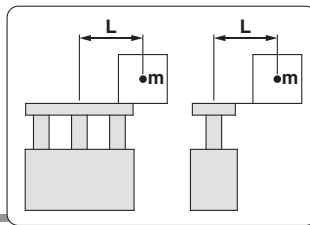

— Operating pressure 0.5 MPa

MGPWL32 to 63, MGPWA32 to 63

(14) 50 stroke or less, $V = 400$ mm/s

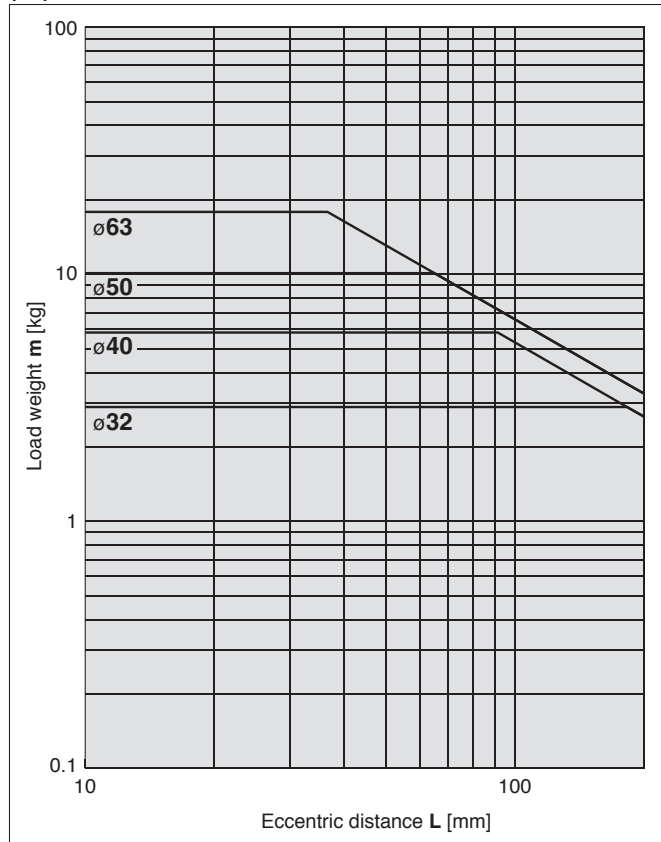

(15) Over 51 stroke, 100 stroke or less, $V = 400$ mm/s

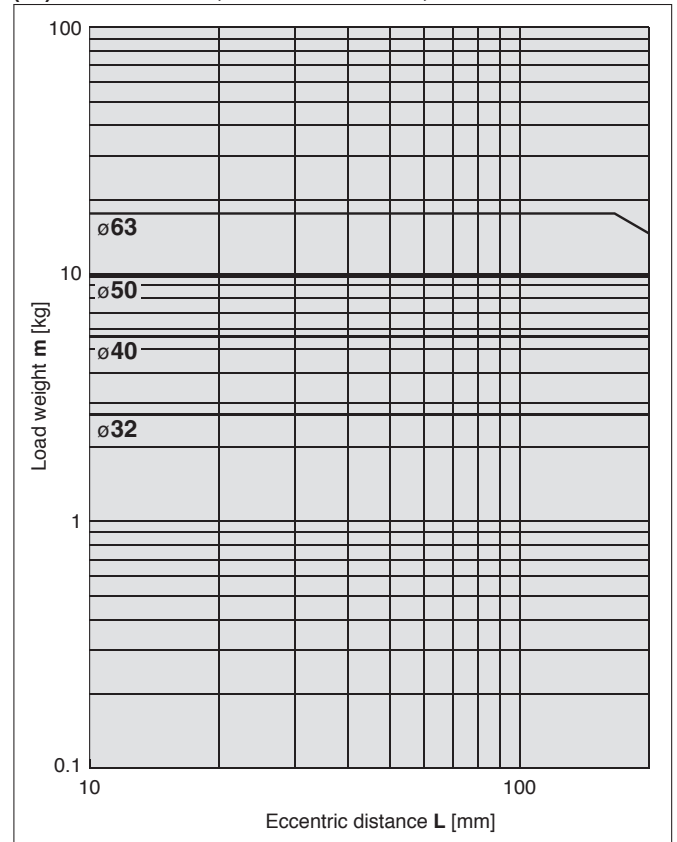

(16) Over 101 stroke, 200 stroke or less, $V = 400$ mm/s

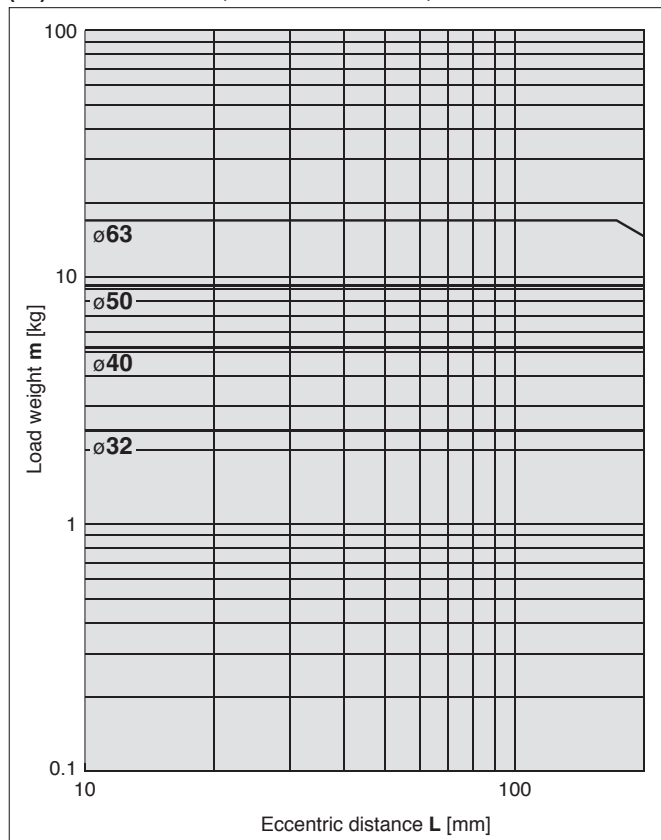

Horizontal Mounting **Slide bearing**

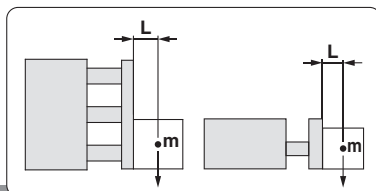

MGPWM20 to 63

(17) L = 50 mm, V = 200 mm/s or less

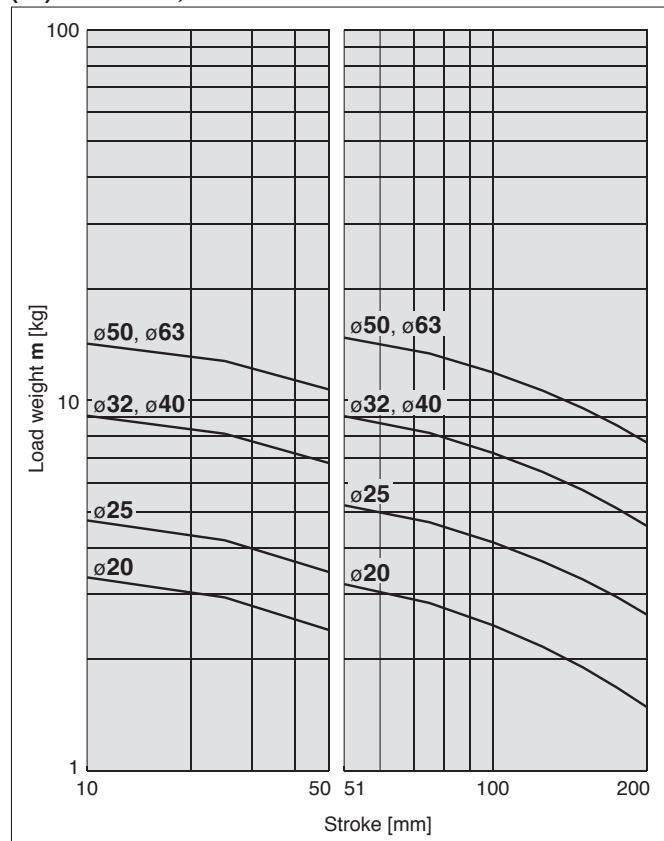

(18) L = 100 mm, V = 200 mm/s or less

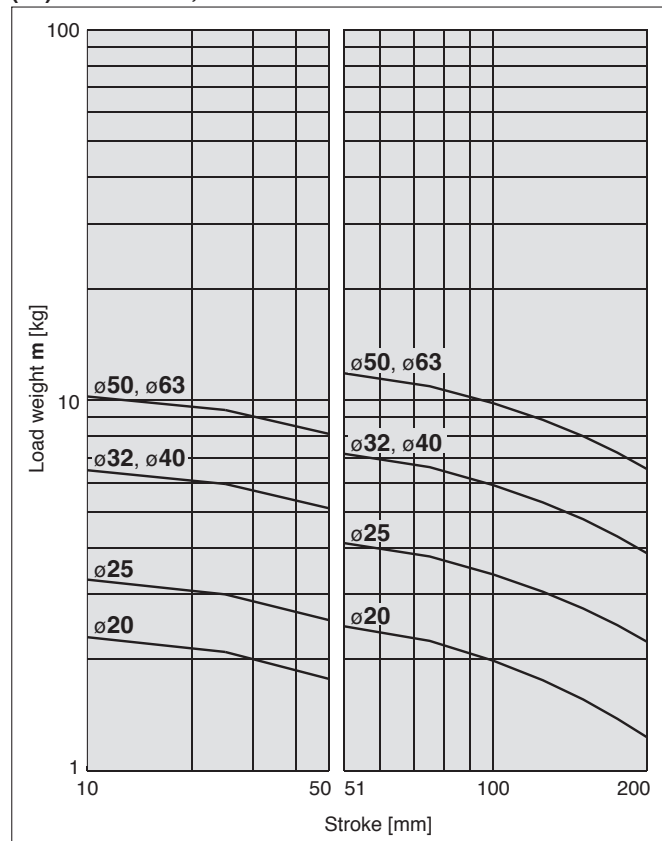

(19) L = 50 mm, V = 400 mm/s

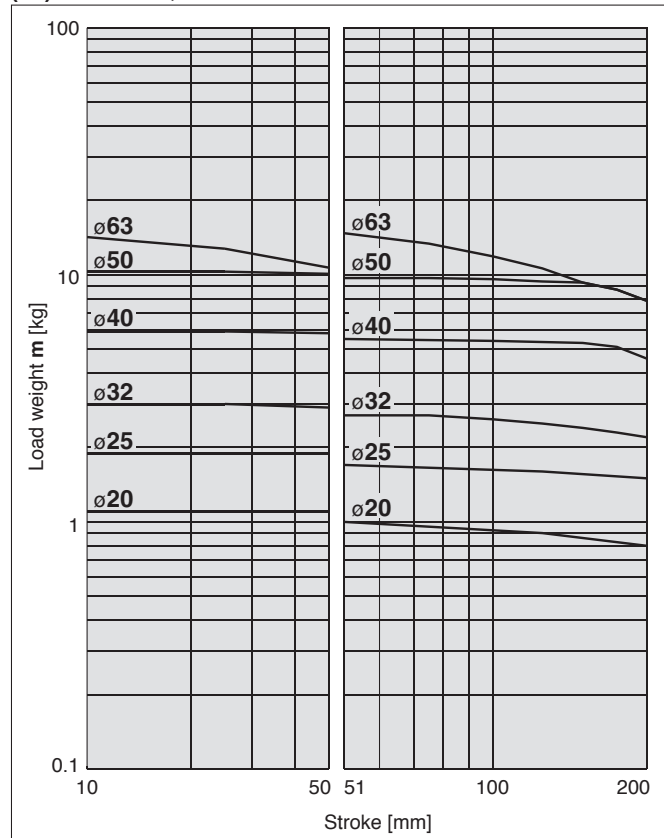

(20) L = 100 mm, V = 400 mm/s

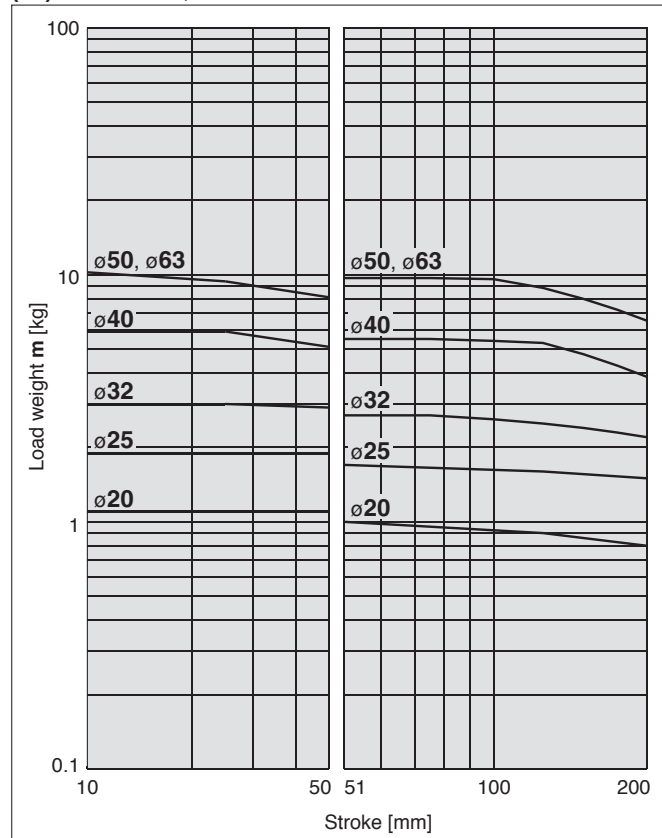

Horizontal Mounting **Ball bushing**

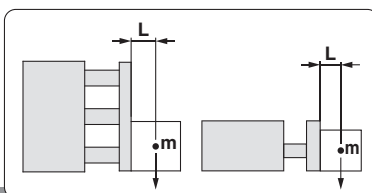

MGPWL20 to 25, MGPWA20 to 25

(21) L = 50 mm, V = 200 mm/s or less

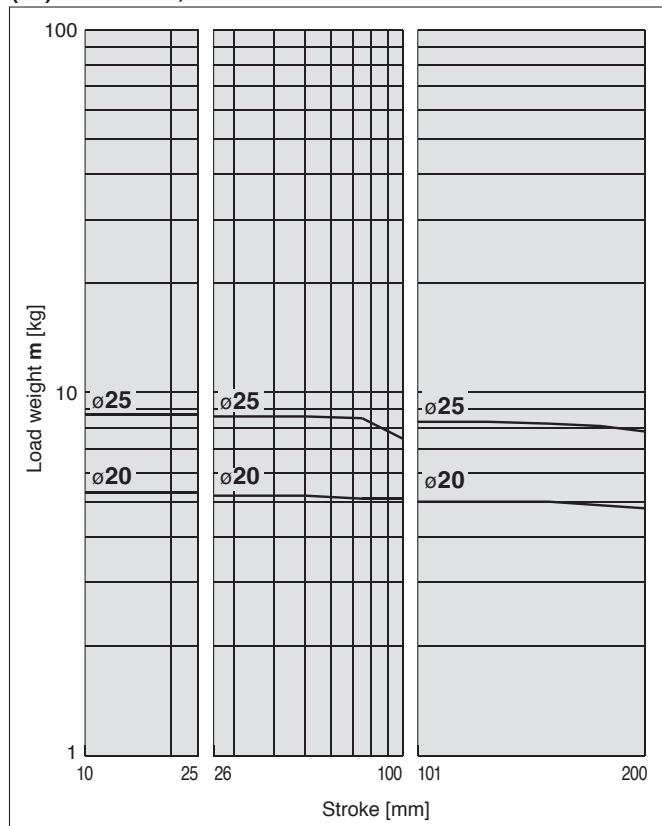

(23) L = 50 mm, V = 200 mm/s or less

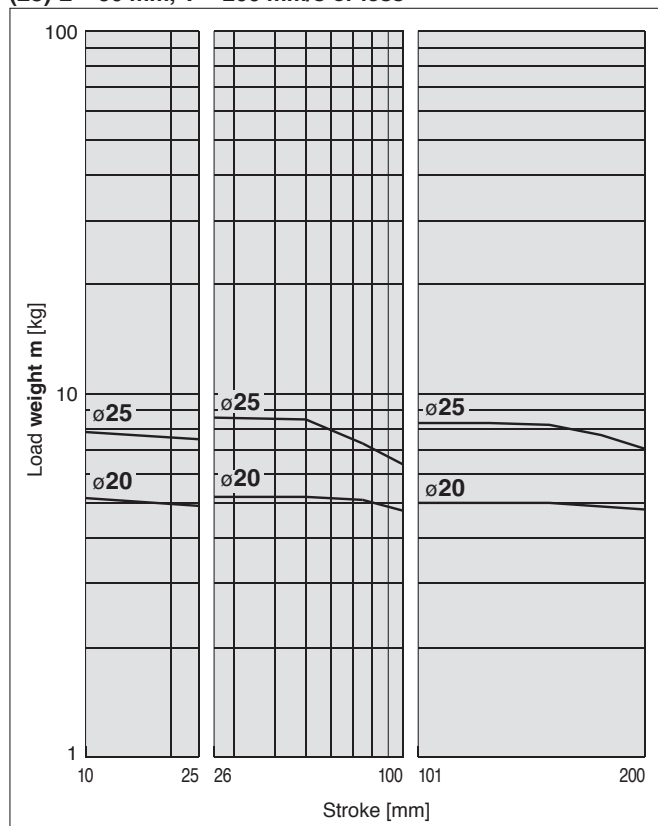

MGPWL32 to 63, MGPWA32 to 63

(22) L = 100 mm, V = 200 mm/s or less

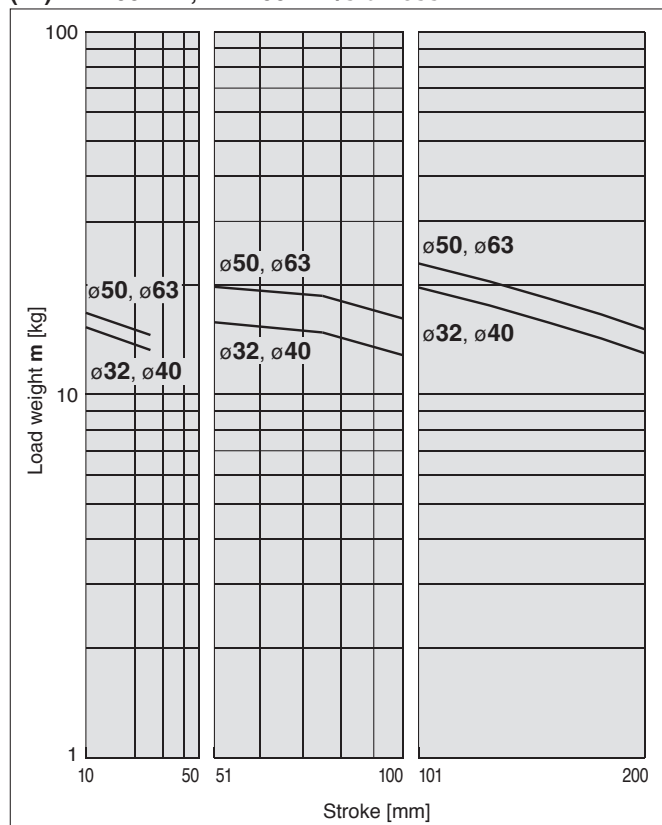

(24) L = 100 mm, V = 200 mm/s or less

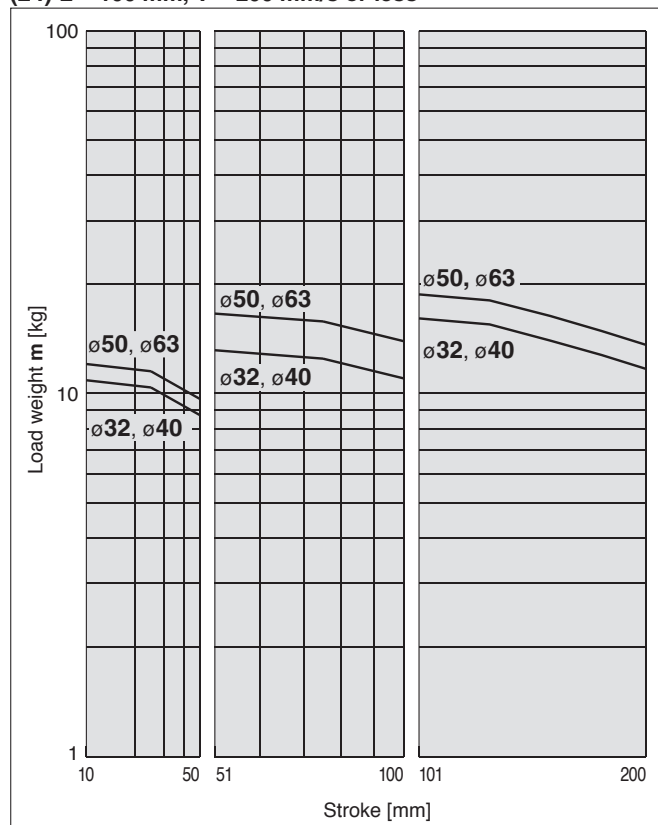

Horizontal Mounting **Ball bushing**

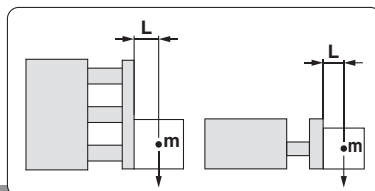

MGPWL20 to 25, MGPWA20 to 25

(25) L = 50 mm, V = 400 mm/s or less

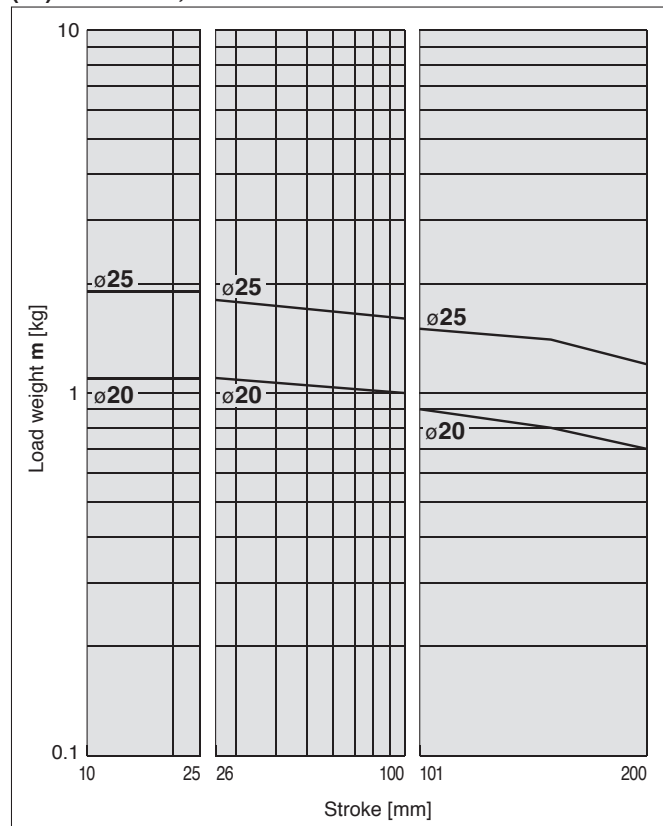

(27) L = 50 mm, V = 400 mm/s or less

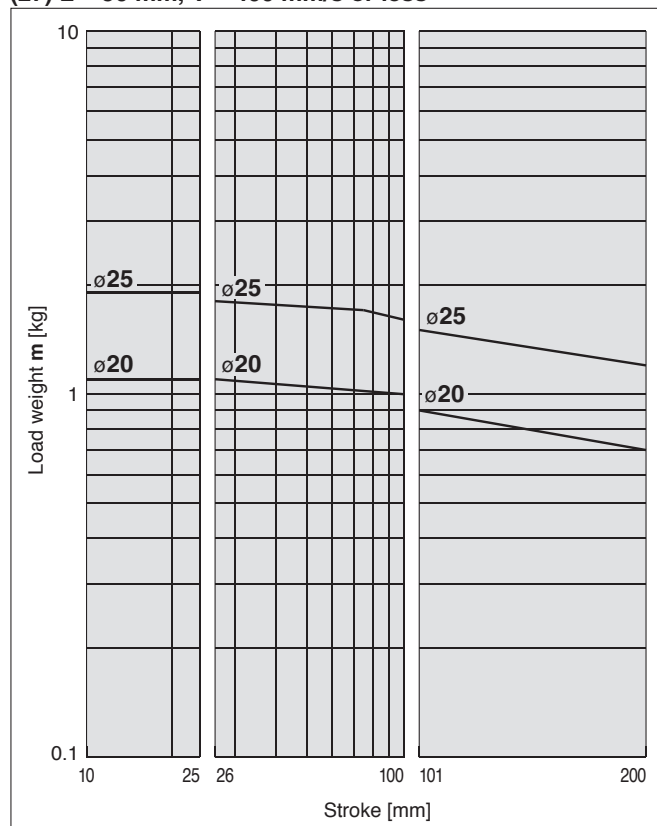

MGPWL32 to 63, MGPWA32 to 63

(26) L = 100 mm, V = 400 mm/s or less

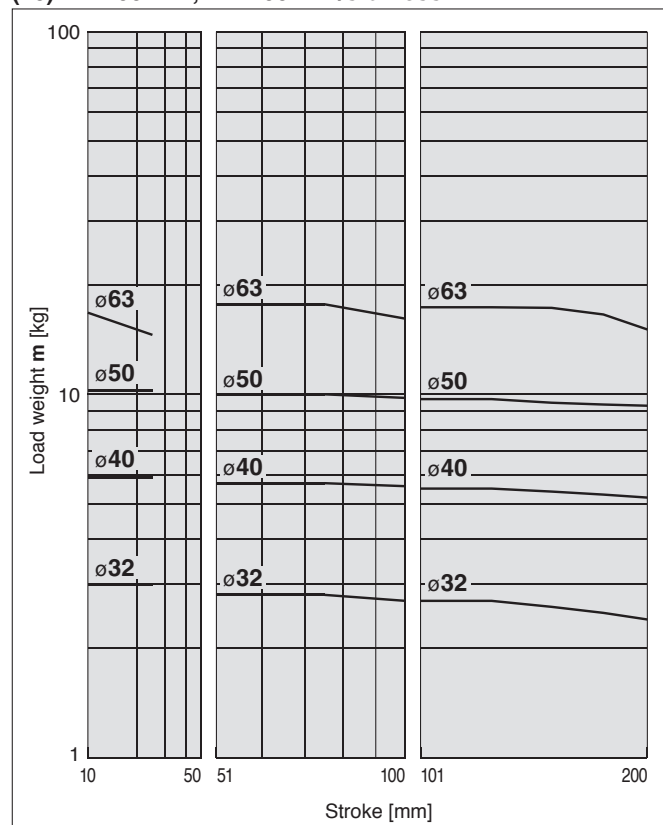

(28) L = 100 mm, V = 400 mm/s or less

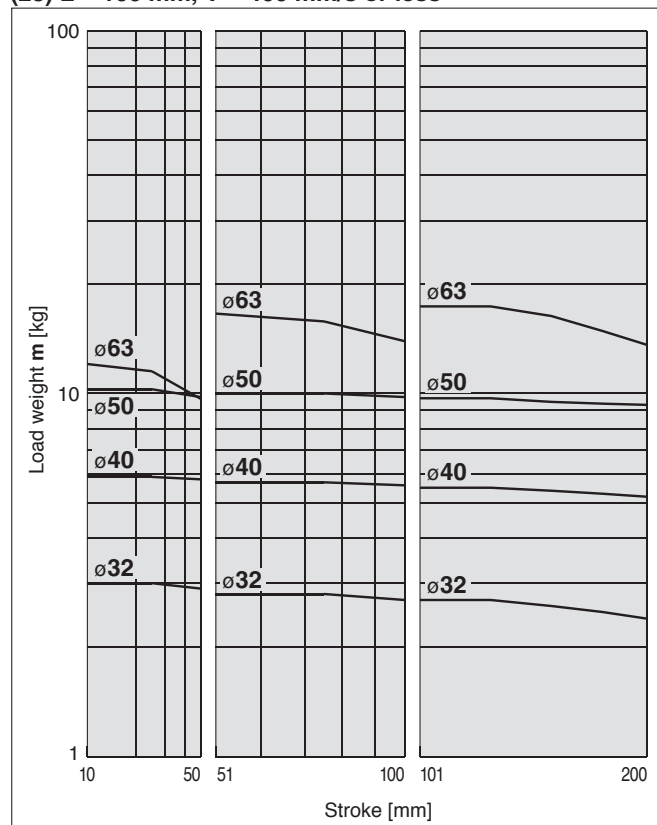

Construction/Series MGPWM, MGPWL, MGPWA

MGPWM20 to 63

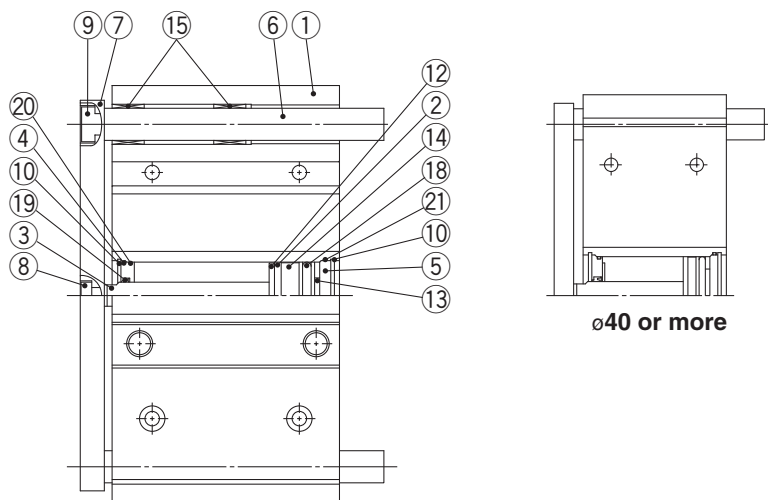

MGPWL20 to 63 MGPWA20 to 63

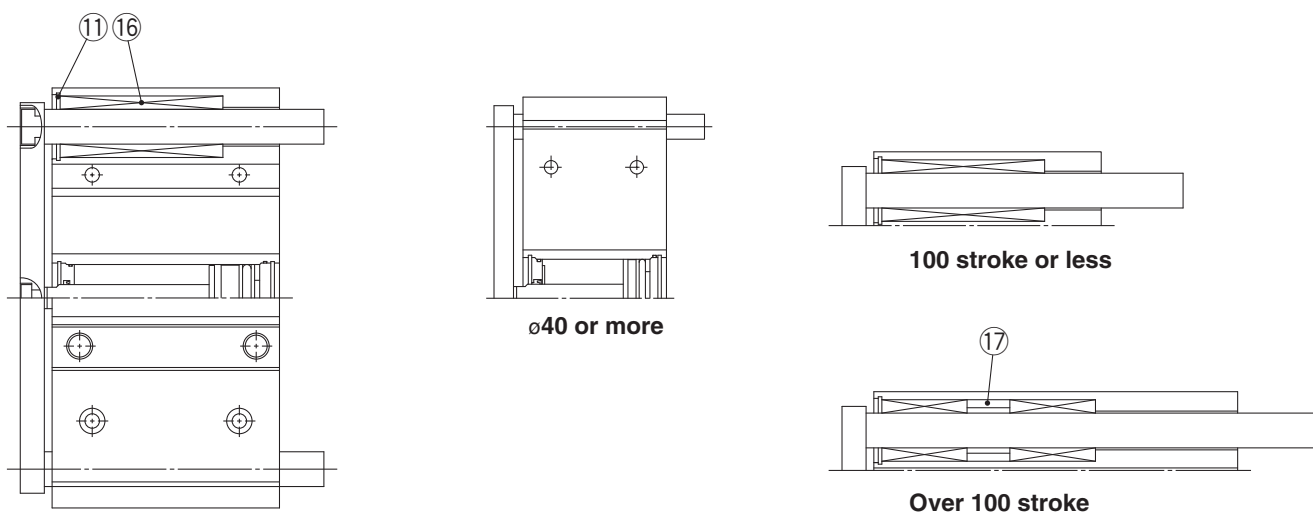

Component Parts

No.	Description	Material	Note
1	Body	Aluminium alloy	Hard anodised
2	Piston	Aluminium alloy	Chromated
3	Piston rod	Stainless steel	ø20 to ø25
		Carbon steel	ø32 to ø63 Hard chrome plated
4	Collar	Aluminium alloy	Chromated
5	Head cover	Aluminium alloy	Chromated
6	Guide rod	Carbon steel	Hard chrome plated
7	Plate	Aluminium alloy	Anodised
8	Plate mounting bolt	Carbon steel	Nickel plated
9	Guide bolt	Carbon steel	Nickel plated
10	Retaining ring	Carbon tool steel	Phosphate coated
11	Retaining ring	Carbon tool steel	Phosphate coated
12	Bumper A	Urethane	
13	Bumper B	Urethane	
14	Magnet	—	
15	Slide bearing	Babbitt	

Component Parts

No.	Description	Material	Note
16	Ball bushing		
17	Spacer	Aluminium alloy	
18*	Piston seal	NBR	
19*	Rod seal	NBR	
20*	Gasket A	NBR	
21*	Gasket B	NBR	

Replacement Parts/Seal Kit

Bore size [mm]	Kit no.	Contents	Bore size [mm]	Kit no.	Contents
20	MGP20-Z-PS	Set of nos. above (18, 19, 20, 21)	40	MGP40-Z-PS	Set of nos. above (18, 19, 20, 21)
25	MGP25-Z-PS		50	MGP50-Z-PS	
32	MGP32-Z-PS		63	MGP63-Z-PS	

* Seal kit includes (18) to (21). Order the seal kit, based on each bore size.

* Since the seal kit does not include a grease pack, order it separately.

Grease pack part no.: GR-S-010 (10 g)

Ø20 to Ø63/MGPWM

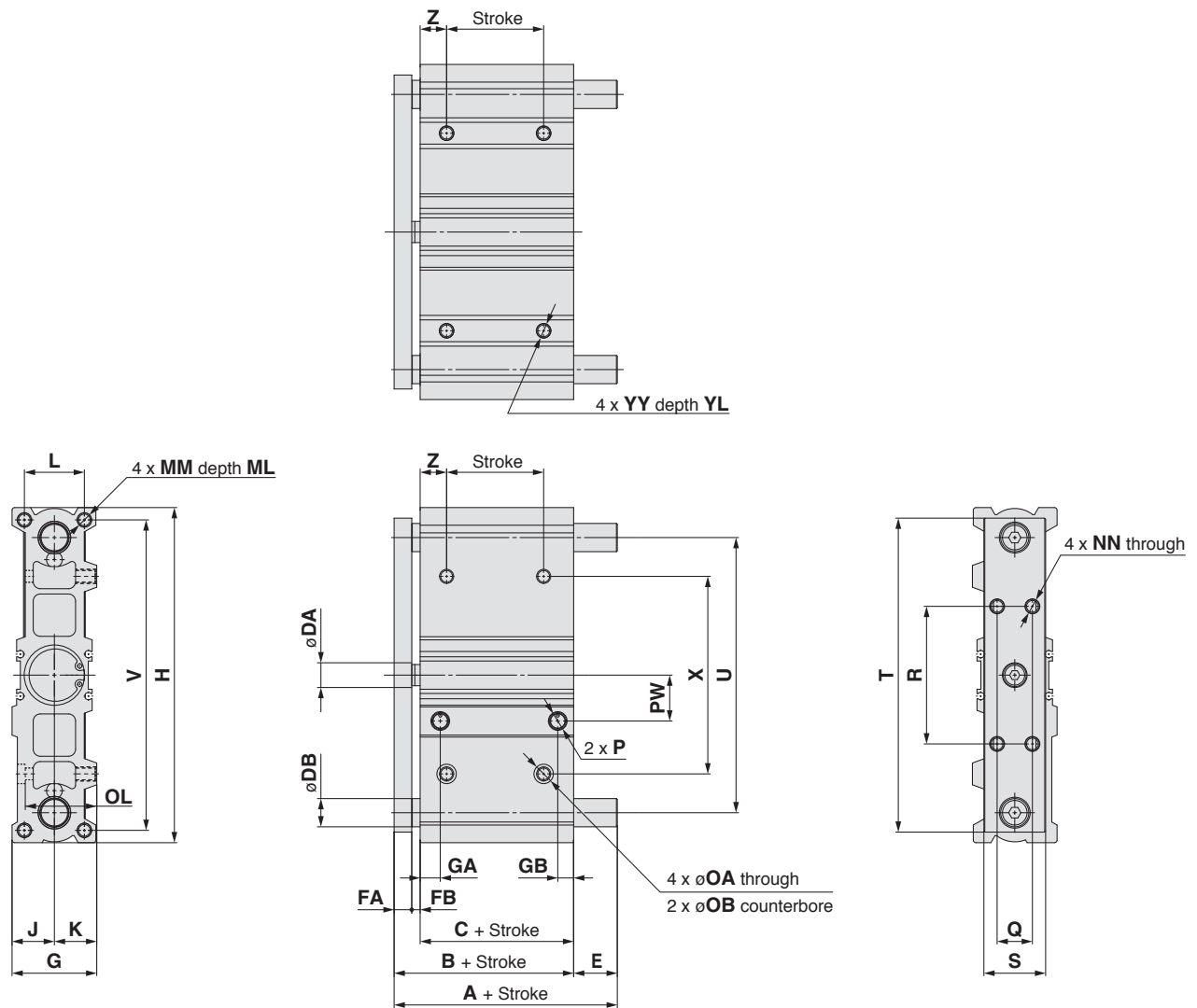

* For intermediate strokes other than standard strokes, refer to "Manufacture of Intermediate Strokes" on page 3.

MGPWM Common Dimensions

[mm]

Bore size [mm]	Standard stroke [mm]			A		B	C	DA	DB	E		FA	FB	G	GA	GB	H	J	K	L
				50 st or less	Over 50 stroke					50 st or less	Over 50 stroke									
20	25, 50, 75, 100, 125, 150, 175, 200			62	92	44.5	34	10	10	17.5	47.5	7.5	3	36	9.9	7.5	137	18	18	24
25				63.5	113.5	47	35	10	12	16.5	66.5	9	3	42	10.3	8.7	157	21	21	30
32				76.5	116.5	52	37	14	16	24.5	64.5	10	5	48	11.4	9	190	24	24	34
40				76.5	116.5	56	41	14	16	20.5	60.5	10	5	54	13.5	10.5	206	27	27	40
50				85	135	60.5	42	18	20	24.5	74.5	12.5	6	64	14	11.1	258	32	32	46
63				85	135	67.5	49	18	20	17.5	67.5	12.5	6	78	15.5	13.5	286	39	39	58

Bore size [mm]	MM	ML	NN	OA	OB	OL	P			PW	Q	R	S	T	U	V	X	YY	YL	Z
							—	TN	TF											
20	M5 x 0.8	13	M5 x 0.8	5.4	9.5	30.5	Rc1/8	NPT1/8	G1/8	17	14	64	24	123	108	126	76	M6 x 1	9	20
25	M6 x 1	15	M6 x 1	5.4	9.5	36.5	Rc1/8	NPT1/8	G1/8	18	16	68	26	146	128	146	92	M6 x 1	9	20
32	M8 x 1.25	20	M8 x 1.25	6.7	11	40.5	Rc1/8	NPT1/8	G1/8	26	20	78	35	178	156	176	112	M8 x 1.25	12	20
40	M8 x 1.25	20	M8 x 1.25	6.7	11	46.5	Rc1/8	NPT1/8	G1/8	27	20	92	35	193	172	192	128	M8 x 1.25	12	23
50	M10 x 1.5	22	M10 x 1.5	8.6	14	54.5	Rc1/4	NPT1/4	G1/4	28.5	26	132	44	247	220	240	168	M10 x 1.5	15	25
63	M10 x 1.5	22	M10 x 1.5	8.6	14	68.5	Rc1/4	NPT1/4	G1/4	30	30	160	48	274	248	266	196	M10 x 1.5	15	27

Ø20 to Ø63/MGPWL, MGPWA

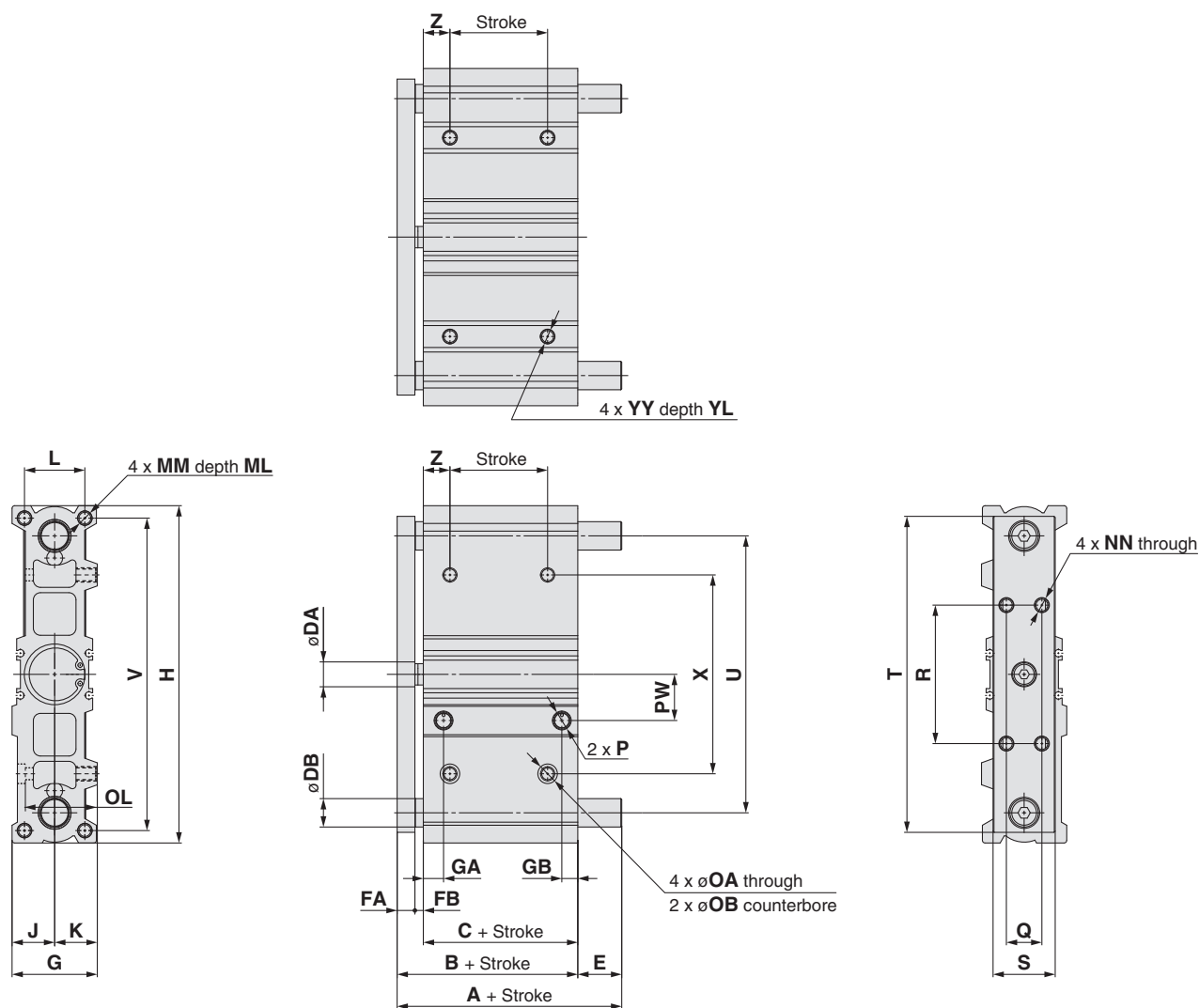

* For intermediate strokes other than standard strokes, refer to "Manufacture of Intermediate Strokes" on page 3.

MGPWL, MGPWA Common Dimensions

[mm]

Bore size [mm]	Standard stroke [mm]	B	C	DA	DB	FA	FB	G	GA	GB	H	J	K	L	MM	ML
20	25, 50, 75, 100, 125, 150, 175, 200	44.5	34	10	10	7.5	3	36	9.9	7.5	137	18	18	24	M5 x 0.8	13
25		47	35	10	13	9	3	42	10.3	8.7	157	21	21	30	M6 x 1	15
32		52	37	14	16	10	5	48	11.4	9	190	24	24	34	M8 x 1.25	20
40		56	41	14	16	10	5	54	13.5	10.5	206	27	27	40	M8 x 1.25	20
50		60.5	42	18	20	12.5	6	64	14	11.1	258	32	32	46	M10 x 1.5	22
63		67.5	49	18	20	12.5	6	78	15.5	13.5	286	39	39	58	M10 x 1.5	22

Bore size [mm]	NN	OA	OB	OL	P			PW	Q	R	S	T	U	V	X	YY	YL	Z
					—	TN	TF											
20	M5 x 0.8	5.4	9.5	30.5	Rc1/8	NPT1/8	G1/8	17	14	64	24	123	108	126	76	M6 x 1	9	20
25	M6 x 1	5.4	9.5	36.5	Rc1/8	NPT1/8	G1/8	18	16	68	26	146	128	146	92	M6 x 1	9	20
32	M8 x 1.25	6.7	11	40.5	Rc1/8	NPT1/8	G1/8	26	20	78	35	178	156	176	112	M8 x 1.25	12	20
40	M8 x 1.25	6.7	11	46.5	Rc1/8	NPT1/8	G1/8	27	20	92	35	193	172	192	128	M8 x 1.25	12	23
50	M10 x 1.5	8.6	14	54.5	Rc1/4	NPT1/4	G1/4	28.5	26	132	44	247	220	240	168	M10 x 1.5	15	25
63	M10 x 1.5	8.6	14	68.5	Rc1/4	NPT1/4	G1/4	30	30	160	48	274	248	266	196	M10 x 1.5	15	27

MGPWL, MGPWA Ø20, Ø25/A, E Dimensions

[mm]

Bore size [mm]	A			E		
	25 st or less	Over 25 st 100 st or less	Over 100 st	25 st or less	Over 25 st 100 st or less	Over 100 st
20	53.5	70.5	94.5	9	26	50
25	61.5	77.5	96.5	14.5	30.5	49.5

MGPWL, MGPWA Ø32 to Ø63/A, E Dimensions

[mm]

Bore size [mm]	A			E		
	50 st or less	Over 50 st 100 st or less	Over 100 st	50 st or less	Over 50 st 100 st or less	Over 100 st
32	72.5	89.5	109.5	20.5	37.5	57.5
40	72.5	89.5	109.5	16.5	33.5	53.5
50	82	103	123	21.5	42.5	62.5
63	82	103	123	14.5	35.5	55.5

Auto Switch Mounting 1

Auto Switch Proper Mounting Position (Detection at Stroke End) and Its Mounting Height

D-M9□
D-M9□V
D-M9□W
D-M9□WV
D-M9□A
D-M9□AV
D-A9□
D-A9□V

ø20 to ø63

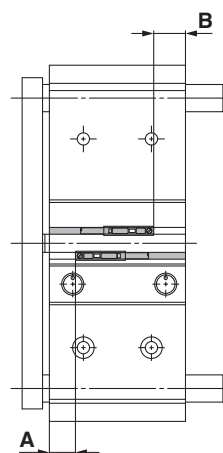
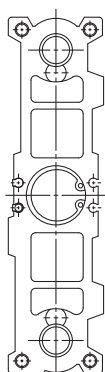
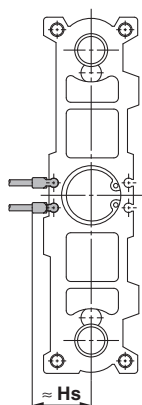

D-P3DWA

ø32 to ø63

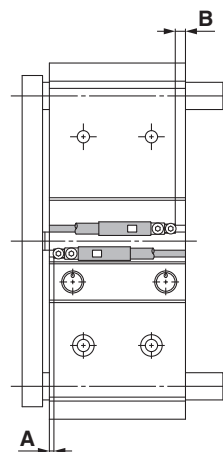
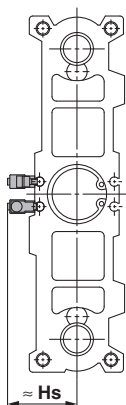

Auto Switch Proper Mounting Position

Applicable Cylinder Series: MGPW

[mm]

Auto switch model Bore size [mm]	D-M9□ D-M9□V D-M9□W D-M9□WV D-M9□A D-M9□AV		D-A9□ D-A9□V		D-P3DW	
	A	B	A	B	A	B
20	11	11	7	7	—	—
25	10.5	12.5	6.5	8.5	6	8
32	12	13	8	9	7.5	8.5
40	14	15	10	11	9.5	10.5
50	13.5	16	9.5	12	9	11.5
63	16.5	20	12.5	16	12	15.5

Note) Adjust the auto switch after confirming the operating conditions in the actual setting.

Auto Switch Mounting Height

[mm]

Auto switch model Bore size [mm]	D-M9□V D-M9□WV D-M9□AV	D-A9□V	D-P3DWA
	Hs	Hs	Hs
20	24.5	22	—
25	26	24	32.5
32	29	26.5	35.5
40	33	30.5	39
50	38.5	36	44.5
63	45.5	43	51.5

Auto Switch Mounting 2

Minimum Stroke for Auto Switch Mounting

[mm]

Auto switch model	No. of auto switches mounted	ø20	ø25	ø32	ø40	ø50	ø63
D-M9□	1 pc.	5 Note 1)			5		
	2 pcs.	10					
D-M9□W	1 pc.	5 Note 2)					
	2 pcs.	10					
D-M9□WV D-M9□AV	1 pc.	5 Note 2)					
	2 pcs.	10					
D-M9□A	1 pc.	5 Note 2)					
	2 pcs.	10 Note 2)					
D-M9□V	1 pc.	5					
	2 pcs.	5					
D-A9□V	1 pc.	5					
	2 pcs.	10					
D-A9□	1 pc.	5					
	2 pcs.	10					
D-P3DW <small>Note 3)</small>	1 pc.	—			15		
	2 pcs.	—			15		

Note 1) Confirm that it is possible to secure the minimum bending radius of 10 mm of the auto switch lead wire before use.

Note 2) Confirm that it is possible to securely set the auto switch(es) within the range of indicator green light ON range before use.

For in-line entry type, please also consider Note 1) shown above.

Note 3) The D-P3DW can be mounted on bore sizes ø32 to ø63.

Other than the applicable auto switches listed in “How to Order”, the following auto switches are mountable.

Refer to Auto Switch Guide for detailed specifications.

Type	Model	Electrical entry	Features
Solid state switch	D-P4DW	Grommet (In-line)	Diagnostic indication (2-colour display) Bore size: ø32 to ø63

* With pre-wired connector is also available for solid state auto switches. For details, refer to Auto Switch Guide.

* Normally closed (NC = b contact) solid state auto switches (D-F9G/F9H) are also available. For details, refer to Auto Switch Guide.

* When installing the D-P4DW, use the BMG7-032 auto switch mounting bracket.

Auto Switch Mounting Brackets/Part No.

Applicable Cylinder Series: MGPWM, MGPWL, MGPWA

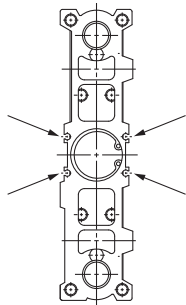
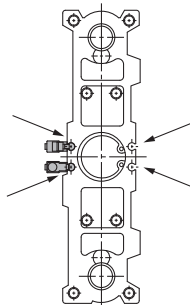
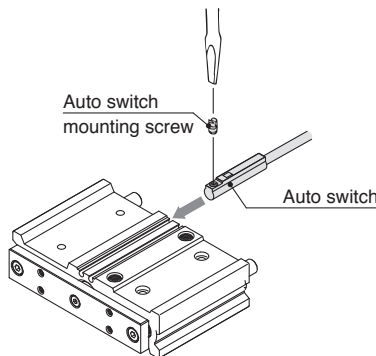
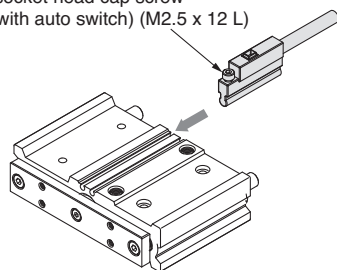
Applicable auto switches	D-M9□/M9□V D-M9□W/M9□WV D-M9□A/M9□AV D-A9□/A9□V	D-P3DWA				
Bore size (mm)	ø20 to ø63	ø32 to ø63				
Auto switch mounting bracket part no.	—	—				
Auto switch mounting bracket fitting parts lineup/Weight	—	—				
Auto switch mounting surfaces	Surfaces with auto switch mounting slot	Surfaces with auto switch mounting slot				
						
Mounting of auto switch	<div><p>Auto switch mounting screw</p><p>Auto switch</p><p>• When tightening the auto switch mounting screw, use a watchmakers' screwdriver with a handle 5 to 6 mm in diameter.</p><p>Tightening Torque for Auto Switch Mounting Screw [N·m]</p><table><tr><th>Auto switch model</th><th>Tightening torque</th></tr><tr><td>D-M9□(V) D-M9□W(V) D-M9□A(V) D-A9□(V)</td><td>0.05 to 0.15 0.10 to 0.20</td></tr></table></div>	Auto switch model	Tightening torque	D-M9□(V) D-M9□W(V) D-M9□A(V) D-A9□(V)	0.05 to 0.15 0.10 to 0.20	<div><p>① Insert the mounting bracket into the mating groove of the cylinder tube.</p><p>② Check the detecting position of the auto switch and fix the auto switch firmly with the hexagon socket head cap screw (M2.5 x 12 L).*</p><p>③ If the detecting position is changed, go back to step ①.</p><p>Note 1) Ensure that the auto switch is covered with the mating groove to protect the auto switch.</p><p>Note 2) The tightening torque for the hexagon socket head cap screw (M2.5 x 12 L) is 0.2 to 0.3 N·m.</p><p>Hexagon socket head cap screw (Included with auto switch) (M2.5 x 12 L)</p></div>
Auto switch model	Tightening torque					
D-M9□(V) D-M9□W(V) D-M9□A(V) D-A9□(V)	0.05 to 0.15 0.10 to 0.20					

Note) Auto switch mounting brackets and auto switches are enclosed with the cylinder for shipment.
 For an environment that needs the water-resistant auto switch, select the D-M9□A(V) type.

Prior to Use

Auto Switch Connection and Example

Sink Input Specifications

3-wire, NPN

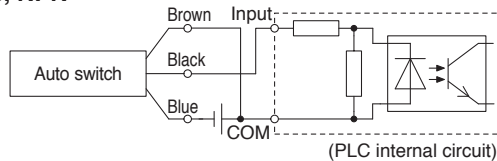

2-wire

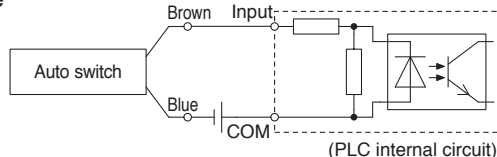

Source Input Specifications

3-wire, PNP

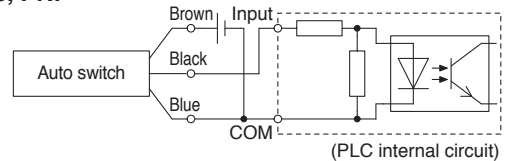

2-wire

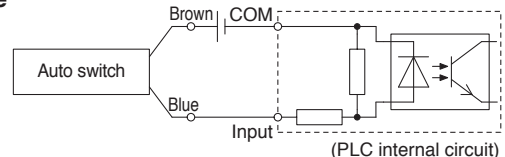

Connect according to the applicable PLC input specifications, as the connection method will vary depending on the PLC input specifications.

Example of AND (Series) and OR (Parallel) Connection

3-wire, AND connection for NPN output (Using relays)

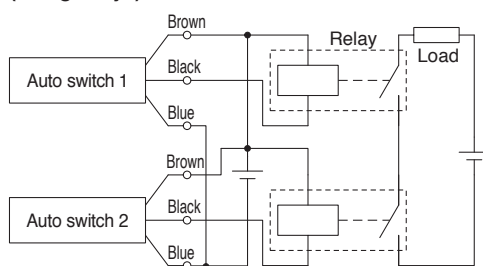

(Performed with auto switches only)

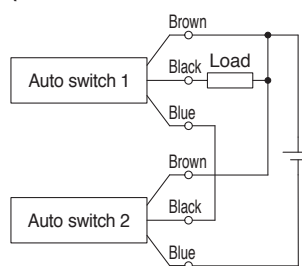

3-wire, OR connection for NPN output

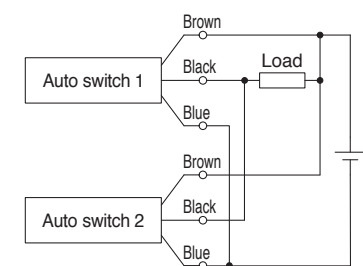

3-wire, AND connection for PNP output (Using relays)

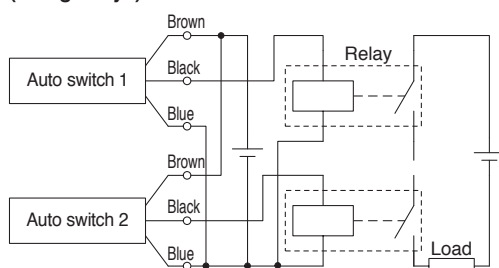

(Performed with auto switches only)

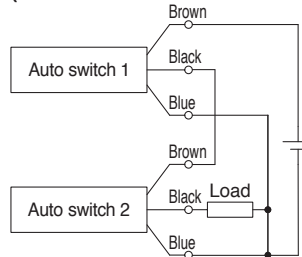

3-wire, OR connection for PNP output

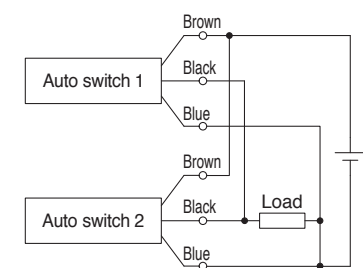

2-wire, AND connection

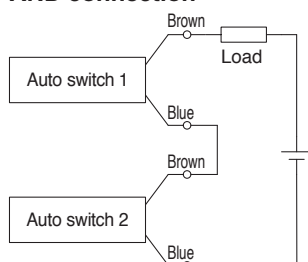

When two auto switches are connected in series, malfunction may occur because the load voltage will decrease in the ON state. The indicator lights will light up when both of the auto switches are in the ON state.

$$\begin{aligned} \text{Load voltage at ON} &= \text{Power supply voltage} - \text{Residual voltage} \times 2 \text{ pcs.} \\ &= 24 \text{ V} - 4 \text{ V} \times 2 \text{ pcs.} \\ &= 16 \text{ V} \end{aligned}$$

Example: Power supply voltage 24 VDC
Auto switch internal voltage drop 4 V

2-wire, OR connection

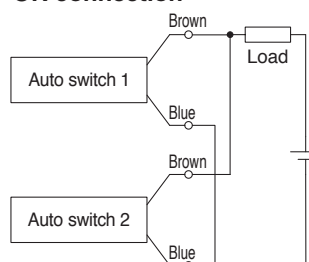

(Solid state)
When two auto switches are connected in parallel, malfunction may occur because the load voltage will increase in the OFF state.

(Reed)
Because there is no leakage current, the load voltage will not increase in the OFF state. However, depending on the number of auto switches in the ON state, the indicator lights may sometimes grow dim or not light up, due to the dispersion and reduction of the current flowing to the auto switches.

$$\begin{aligned} \text{Load voltage at OFF} &= \text{Leakage current} \times 2 \text{ pcs.} \times \text{Load impedance} \\ &= 1 \text{ mA} \times 2 \text{ pcs.} \times 3 \text{ k}\Omega \\ &= 6 \text{ V} \end{aligned}$$

Example: Load impedance 3 kΩ
Auto switch leakage current 1 mA

Series MGPW

Made to Order 1

Please contact SMC for detailed dimensions, specifications, and lead times.



1 With Knock Pin Holes

Symbol
-XC56

Cylinder with knock positioning pin hole

How to Order

MGPW Standard model no. -XC56
 • With knock pin holes

Specifications: Same as standard type

Dimensions (Dimensions other than below are the same as standard type.)

Bore size [mm]	HA	HB	N	RA	XA	XB
20	25 ±0.02	25 ±0.02	3 ^{H7} ₀ ^{+0.010} depth 6	28 ±0.02	17	76 ±0.03
25	28 ±0.02	28 ±0.02	4 ^{H7} ₀ ^{+0.012} depth 6	34 ±0.02	18	92 ±0.03
32	34 ±0.02	34 ±0.02	4 ^{H7} ₀ ^{+0.012} depth 6	42 ±0.02	19	112 ±0.03
40	38 ±0.02	38 ±0.02	4 ^{H7} ₀ ^{+0.012} depth 6	50 ±0.02	21	128 ±0.04
50	49 ±0.02	49 ±0.02	5 ^{H7} ₀ ^{+0.012} depth 8	65 ±0.03	21	168 ±0.04
63	58 ±0.03	58 ±0.03	5 ^{H7} ₀ ^{+0.012} depth 8	80 ±0.03	25	196 ±0.04

Bottom of the cylinder

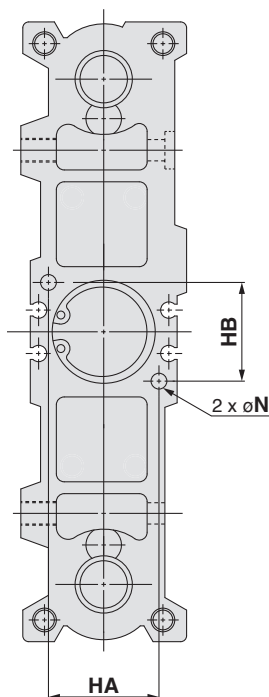

Side of the cylinder (Bottom)

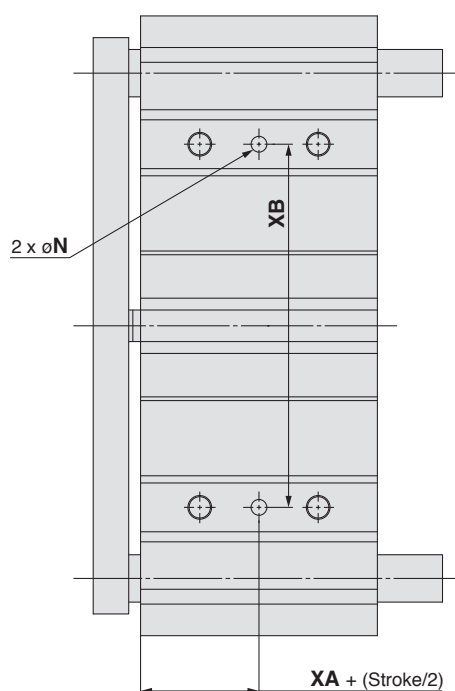

Top of the plate

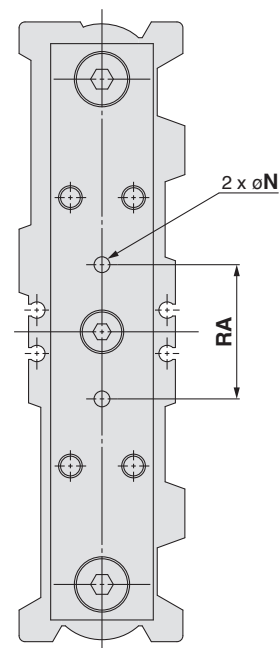

Series MGPW

Made to Order 2

Please contact SMC for detailed dimensions, specifications, and lead times.



2 Side Porting Type

Symbol
-X867

Ports are only on the top of the cylinder for the standard model, but side ports are also available.

How to Order

MGPW Standard model no. **-X867**
 • Side porting type

Port positions

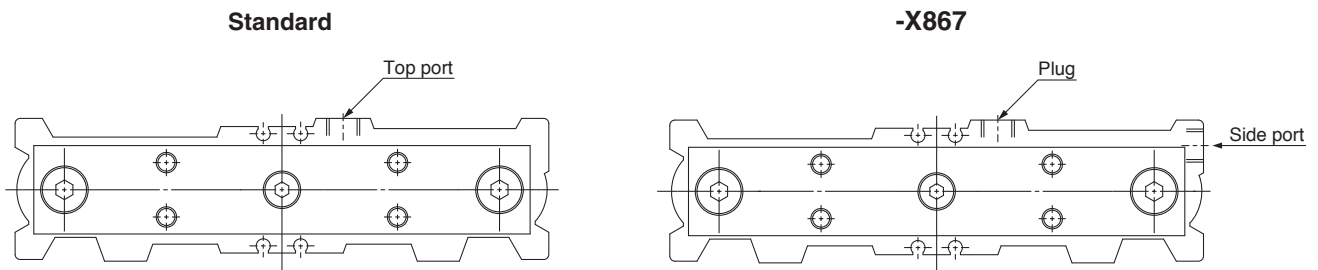

Specifications: Same as standard type

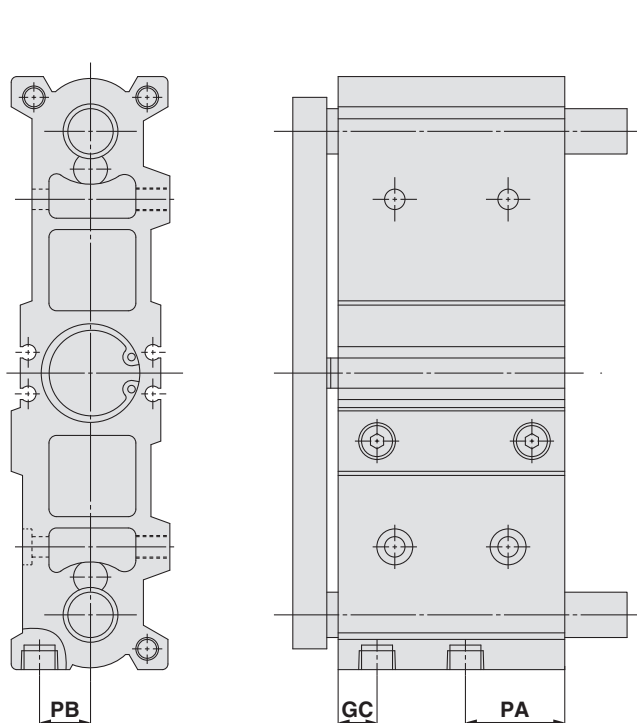

Dimensions (Dimensions other than below are the same as standard type.)



[mm]			
Bore size [mm]	GC	PA	PB
20	9.9	23.5	10.5
25	10.3	25	13.5
32	11.4	31	16
40	13.5	31	18
50	14	35	21.5
63	15.5	36	28

Safety Instructions

These safety instructions are intended to prevent hazardous situations and/or equipment damage. These instructions indicate the level of potential hazard with the labels of “**Caution**,” “**Warning**” or “**Danger**.” They are all important notes for safety and must be followed in addition to International Standards (ISO/IEC)*1), and other safety regulations.

-  **Caution:** **Caution** indicates a hazard with a low level of risk which, if not avoided, could result in minor or moderate injury.
-  **Warning:** **Warning** indicates a hazard with a medium level of risk which, if not avoided, could result in death or serious injury.
-  **Danger:** **Danger** indicates a hazard with a high level of risk which, if not avoided, will result in death or serious injury.

- *1) ISO 4414: Pneumatic fluid power – General rules relating to systems.
ISO 4413: Hydraulic fluid power – General rules relating to systems.
IEC 60204-1: Safety of machinery – Electrical equipment of machines.
(Part 1: General requirements)
ISO 10218-1: Manipulating industrial robots - Safety.
etc.

Warning

1. The compatibility of the product is the responsibility of the person who designs the equipment or decides its specifications.

Since the product specified here is used under various operating conditions, its compatibility with specific equipment must be decided by the person who designs the equipment or decides its specifications based on necessary analysis and test results. The expected performance and safety assurance of the equipment will be the responsibility of the person who has determined its compatibility with the product. This person should also continuously review all specifications of the product referring to its latest catalogue information, with a view to giving due consideration to any possibility of equipment failure when configuring the equipment.

2. Only personnel with appropriate training should operate machinery and equipment.

The product specified here may become unsafe if handled incorrectly. The assembly, operation and maintenance of machines or equipment including our products must be performed by an operator who is appropriately trained and experienced.

3. Do not service or attempt to remove product and machinery/equipment until safety is confirmed.

1. The inspection and maintenance of machinery/equipment should only be performed after measures to prevent falling or runaway of the driven objects have been confirmed.
2. When the product is to be removed, confirm that the safety measures as mentioned above are implemented and the power from any appropriate source is cut, and read and understand the specific product precautions of all relevant products carefully.
3. Before machinery/equipment is restarted, take measures to prevent unexpected operation and malfunction.

4. Contact SMC beforehand and take special consideration of safety measures if the product is to be used in any of the following conditions.

1. Conditions and environments outside of the given specifications, or use outdoors or in a place exposed to direct sunlight.
2. Installation on equipment in conjunction with atomic energy, railways, air navigation, space, shipping, vehicles, military, medical treatment, combustion and recreation, or equipment in contact with food and beverages, emergency stop circuits, clutch and brake circuits in press applications, safety equipment or other applications unsuitable for the standard specifications described in the product catalogue.
3. An application which could have negative effects on people, property, or animals requiring special safety analysis.
4. Use in an interlock circuit, which requires the provision of double interlock for possible failure by using a mechanical protective function, and periodical checks to confirm proper operation.

Caution

1. The product is provided for use in manufacturing industries.

The product herein described is basically provided for peaceful use in manufacturing industries.

If considering using the product in other industries, consult SMC beforehand and exchange specifications or a contract if necessary.

If anything is unclear, contact your nearest sales branch.

Limited warranty and Disclaimer/ Compliance Requirements

The product used is subject to the following “Limited warranty and Disclaimer” and “Compliance Requirements”.

Read and accept them before using the product.

Limited warranty and Disclaimer

1. The warranty period of the product is 1 year in service or 1.5 years after the product is delivered, whichever is first.*2)
Also, the product may have specified durability, running distance or replacement parts. Please consult your nearest sales branch.
2. For any failure or damage reported within the warranty period which is clearly our responsibility, a replacement product or necessary parts will be provided.
This limited warranty applies only to our product independently, and not to any other damage incurred due to the failure of the product.
3. Prior to using SMC products, please read and understand the warranty terms and disclaimers noted in the specified catalogue for the particular products.

*2) Vacuum pads are excluded from this 1 year warranty.

A vacuum pad is a consumable part, so it is warranted for a year after it is delivered. Also, even within the warranty period, the wear of a product due to the use of the vacuum pad or failure due to the deterioration of rubber material are not covered by the limited warranty.

Compliance Requirements

1. The use of SMC products with production equipment for the manufacture of weapons of mass destruction (WMD) or any other weapon is strictly prohibited.
2. The exports of SMC products or technology from one country to another are governed by the relevant security laws and regulations of the countries involved in the transaction. Prior to the shipment of a SMC product to another country, assure that all local laws governing that export are known and followed.

Safety Instructions

Be sure to read “Handling Precautions for SMC Products” (M-E03-3) before using.

SMC Corporation (Europe)

Austria	☎ +43 (0)2262622800	www.smc.at	office@smc.at
Belgium	☎ +32 (0)33551464	www.smc-pneumatics.be	info@smc-pneumatics.be
Bulgaria	☎ +359 (0)2807670	www.smc.bg	office@smc.bg
Croatia	☎ +385 (0)13707288	www.smc.hr	office@smc.hr
Czech Republic	☎ +420 541424611	www.smc.cz	office@smc.cz
Denmark	☎ +45 70252900	www.smc.dk.com	smc@smc.dk.com
Estonia	☎ +372 6510370	www.smc-pneumatics.ee	smc@smc-pneumatics.ee
Finland	☎ +358 207513513	www.smc.fi	smc@smc.fi
France	☎ +33 (0)164761000	www.smc-france.fr	promotion@smc-france.fr
Germany	☎ +49 (0)61034020	www.smc.de	info@smc.de
Greece	☎ +30 210 2717265	www.smc-hellas.gr	sales@smc-hellas.gr
Hungary	☎ +36 23511390	www.smc.hu	office@smc.hu
Ireland	☎ +353 (0)14039000	www.smc-pneumatics.ie	sales@smc-pneumatics.ie
Italy	☎ +39 0292711	www.smc-italia.it	mailbox@smc-italia.it
Latvia	☎ +371 67817700	www.smc.lv	info@smc.lv

Lithuania	☎ +370 5 2308118	www.smclt.lt	info@smclt.lt
Netherlands	☎ +31 (0)205318888	www.smc-pneumatics.nl	info@smc-pneumatics.nl
Norway	☎ +47 67129020	www.smc-norge.no	post@smc-norge.no
Poland	☎ +48 (0)222119616	www.smc.pl	office@smc.pl
Portugal	☎ +351 226166570	www.smc.eu	post@smc-smces.es
Romania	☎ +40 213205111	www.smcromania.ro	smcromania@smcromania.ro
Russia	☎ +7 8127185445	www.smc-pneumatik.ru	info@smc-pneumatik.ru
Slovakia	☎ +421 (0)413213212	www.smc.sk	office@smc.sk
Slovenia	☎ +386 (0)73885412	www.smc.si	office@smc.si
Spain	☎ +34 902184100	www.smc.eu	post@smc-smces.es
Sweden	☎ +46 (0)86031200	www.smc.nu	post@smc.nu
Switzerland	☎ +41 (0)523963131	www.smc.ch	info@smc.ch
Turkey	☎ +90 212 489 0 440	www.smc-pneumatik.com.tr	info@smc-pneumatik.com.tr
UK	☎ +44 (0)845 121 5122	www.smc-pneumatics.co.uk	sales@smc-pneumatics.co.uk

SMC CORPORATION Akihabara UDX 15F, 4-14-1, Sotokanda, Chiyoda-ku, Tokyo 101-0021, JAPAN Phone: 03-5207-8249 FAX: 03-5298-5362

1st printing QX printing QX 00 Printed in Spain

Specifications are subject to change without prior notice and any obligation on the part of the manufacturer.